

Road Petition No. 784
(abandon right-of-way
easement Brackett creek /
film 95 page 4557 Hamesmark
Ranch)

Granted March 10, 1998

film _____ Page _____
Resolution Recorded in
film 182 Page 2135

PETITION TO ABANDON COUNTY ROAD
(APPENDIX A)

TO: THE BOARD OF COUNTY COMMISSIONERS, GALLATIN COUNTY, MONTANA

COME NOW the undersigned freeholders of the road district of Gallatin County, Montana, and petition this board pursuant to Section 7-14-2601, MCA, to abandon a county road located in Gallatin County, Montana and represent as follows:

1. The road to be abandoned is particularly described as follows: See the attached "Description of Property to be Abandoned."

(Attach additional page if required).

2. The road is commonly known as: not applicable.

3. The general route of the road is described as follows:
The road was not constructed.

4. The lands and owners immediately adjacent to the road are:

LANDOWNER(S)

MAILING ADDRESS

1.	<u>Hammersmark Ranch Co.</u>	<u>P.O. Box 2529</u>
		<u>Billings, MT 59103</u>

Easement in Section 5, Township 1 North, Range 7 East.

PROPERTY DESCRIPTION

2.	<u>_____</u>	<u>_____</u>
	<u>_____</u>	<u>_____</u>

PROPERTY DESCRIPTION

3.	<u>_____</u>	<u>_____</u>
	<u>_____</u>	<u>_____</u>

PROPERTY DESCRIPTION

5. Except for the following landowners the landowners identified in Section 3 consent to the abandonment: (If any of the adjacent landowners do not consent identify them in this paragraph)

6. If a landowner stated in Paragraph 3 cannot be found to determine the landowner's consent, identify the landowner and state the efforts made to locate the landowner:

7. To the best of our knowledge the following are landowners, who do not own land immediately adjacent to the road, but who could be affected by the abandonment of the road:

LANDOWNER(S)

MAILING ADDRESS

None

(Use additional pages if required)

8. The necessity for and advantage of the abandonment of the road are as follows: The easement constitutes a burden upon the title to the affected property and serves no useful purpose, either current or contemplated, to the public.

The undersigned state that they are owners of real property in the Gallatin County road district which is taxable for the county general road tax. If more than 10 freeholders sign, use additional pages.

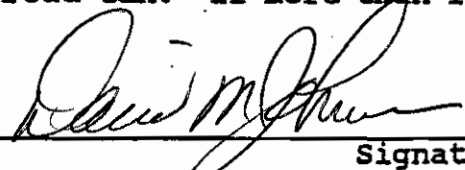
1.  8606 Ricky Drive
Box 1601
Signature Address
OK David M Johnson Bozeman MT 59711
Printed Name City, State & Zip
1-21-98
Date

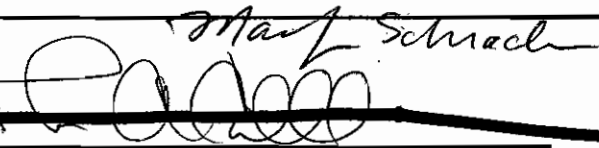
2.  HOUSE
15233 BRACKETT CR RD.
Description of Property
112 WORTH 2ND
Signature Address
MARILYN SCHRADER BOZEMAN, MT 59711
Printed Name City, State & Zip
~~1/23/98~~ 1/27/98
Date

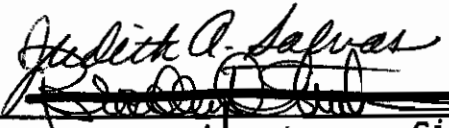
3.  RESIDENCE
46 SUNDANCE TR., BOZEMAN, MT 59718
Description of Property
~~915 S 3rd~~
Signature Address
Judith A. Salvus Bozeman, MT 59718
Printed Name City, State & Zip
January 29, 1998
~~1-23-98~~
Date

House
Description of Property

OK 4.

Carol E Sutton
Signature

5028 Justin Lane
Address

CAROL E SUTTON
Printed Name

Bozeman, MT 59715
City, State & Zip

1-23-98
Date

OK 5.

Sue Frye
Signature

Home
Description of Property

Sue Frye
Printed Name

360 Evening Star Ln.
Address

1/23/98
Date

Bozeman, MT 59715
City, State & Zip

OK 6.

Gerald R. Wain
Signature

Home
Description of Property

Gerald R. Wain
Printed Name

216 Bison Trail
Address

1/23/98
Date

Bozeman MT 59718
City, State & Zip

OK 7.

Pam Grover
Signature

Lot 27 Valley Grove Sub No 1
Description of Property

Pam Grover
Printed Name

8461 Lipine Lane
Address

1/23/98
Date

Bozeman, MT 59718
City, State & Zip

Lot 46, El Dorado Country Estates
Description of Property

8. *OK* John R. Hansen Signature 9424 Cougar DR. Address
John R. Hansen Printed Name Bozeman MT 59711 City, State & Zip
1-23-98 Date

home
Description of Property

9. *OK* Charlotta Hansen Signature 9424 Cougar Dr Address
Charlotta Hansen Printed Name Bozeman MT 59718 City, State & Zip
1-23-98 Date

home
Description of Property

10. *OK* Kathie J. Lang Signature 8605 Ricky Dr Address
KATHIE J. LANG Printed Name BOZEMAN MT 59718 City, State & Zip
1-24-98 Date

home
Description of Property

HAMMERSMARK RANCH CO.

DESCRIPTION OF PROPERTY TO BE ABANDONED

A portion of an undeveloped road easement granted by Hammersmark Ranch Co., a corporation, to Gallatin County, Montana dated February 9, 1987, recorded February 10, 1987 in Film 95, page 4557, records of Gallatin County, Montana. The easement is located in Section 5, Township 1 North, Range 7 East, P.M.M. The easement was obtained in connection with a proposed project with the Montana Department of Transportation to modify the Bracket Creek Road in that section. The project contemplated building one bridge in Section 5 to replace two bridges - one owned by the State and one by the County. Subsequent to the granting of the easement both the State and the County have replaced both bridges with new ones and the project has been abandoned.

This request is for Gallatin County to abandon all portions of the easement not actually within the right-of-way of the Bracket Creek Road as currently constructed.

Exception #18 (Section 5 -T1N/R7E)

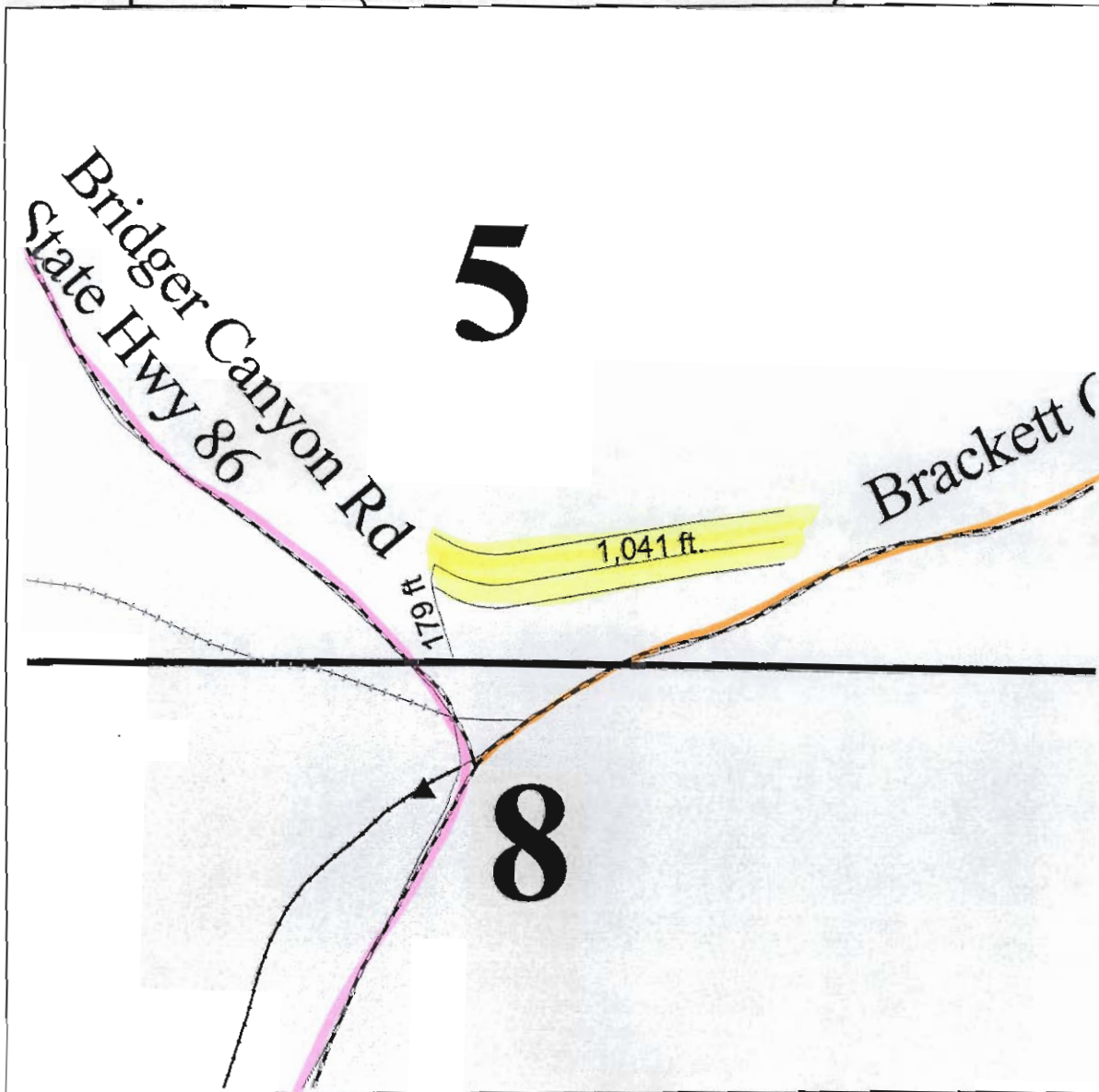

Easement (95-4557).

The geographic description in this easement appears to be inaccurate. The Brackett Creek Road begins at a junction with State Highway 86 in the northern portion of section 8, T01N, R07E. The road angles in a northeast direction through section 5. The total length of this road in section 5, calculated by the GIS using the location provided by Gallatin County derived from GPS, was approximately 2,800 feet. The length of the easement described in the exhibit with Exception 18 is 1,041 feet. The origin, or point of beginning, does not match the two plats received from the Montana Department of Transportation, nor any existing road features. There is no indication that a surveyor prepared this document and it appears to be in error. With the documents provided it is not possible to identify exactly where this easement begins. It is drawn on this exhibit exactly in the position described in the text. The centerline and easements were prepared using coordinate geometry in Autocad by Land and Water Consulting, The Bureau of Land Management GCDB quarter corner was used as the source to begin the COGO. Appendix B is attached.

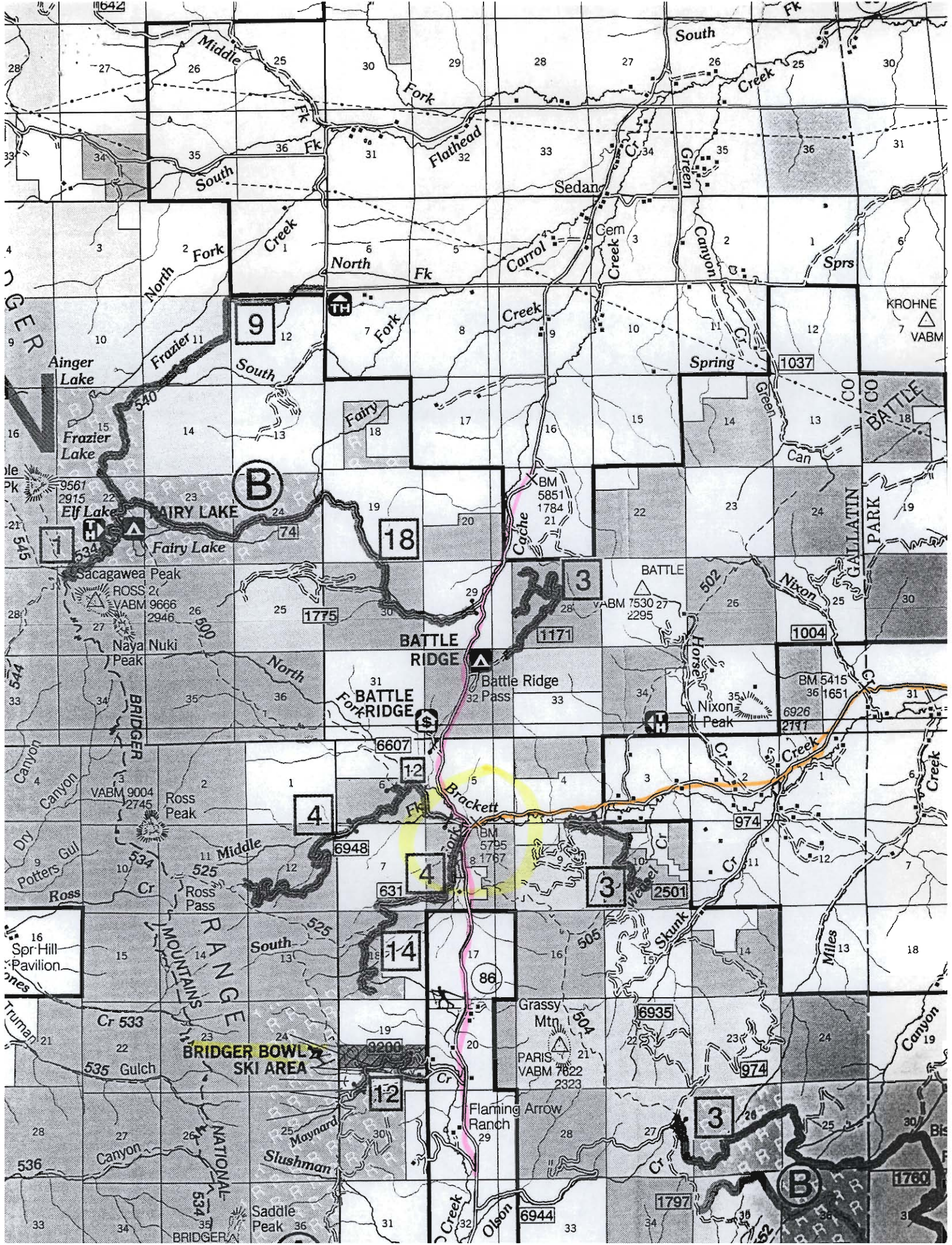

State of Montana

County of Gallatin

Bozeman



**CERTIFICATE OF THE COUNTY CLERK AND RECORDER
RELATING TO
QUALIFICATIONS OF THE SIGNERS**

Statement of Purpose: Petition to abandon a portion of a road easement.

Legal Description: That portion of the road easement described in Film 95 Page 4557 that is not currently within the Right-of-Way of Brackett Creek Road, being 1041' long and located in the S½ of Section 5, Township 1 North, Range 7 East.

STATE OF MONTANA)
)ss
COUNTY OF GALLATIN)

I, Shelley Vance, do hereby certify that I am the qualified and acting County Clerk and Recorder for Gallatin County, State of Montana; that I have examined the petition to which this certificate is attached, and that pursuant to Section 7-14-2601 M.C.A. 1997, it contains the signatures of at least 10 qualified freeholders in Gallatin County.

IN WITNESS WHEREOF, I have hereunto subscribed my name and affixed the seal of my office at Bozeman, the County Seat of Gallatin County, State of Montana, this 29th day of January, 1998, A.D.

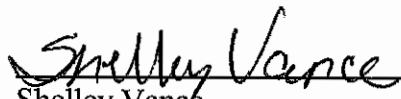
Shelley Vance
Clerk and Recorder
Gallatin County, Montana

CHECKLIST OF PROCEDURES FOR ROAD PETITIONS

Original signed petition must be submitted to the Clerk and Recorder along with a map showing the area of the road under consideration. Stamp the date received on the petition. Get name and phone number of contact person for questions.

NAME Hammersmark Ranch/David Johnson PHONE 587-3090

- 1) Determine if there are sufficient qualified signatures.
- 2) Complete "Report of Qualified Signatures".
- 3) Schedule petition on Commissioner's agenda. DATE: SPECIAL 1/29/98

- 4) Make copies of petition and report. Forward to:
 - County Attorney (attach note of date on Commissioner's agenda)
 - County Road Superintendent (attach note of date on Commissioner's agenda)
 - County Commission (3 copies)

- 5) Commissioners receive petition and assign viewing committee.
- 6) Assign Road Petition Number. 784

- 7) Type regular mail envelopes for:
 - All landowners named on the petition
 - All signers on the petition
 - All individuals named in the petition who could be affected
 - The postmaster of the area
 - The Public Lands Access AssociationType and prepare certified mail envelopes for:
 - All owners of land abutting the road
 - All individuals named in the petition who could be affected
 - The postmaster of the area
 - The Public Lands Access Association

- 8) Viewing committee completes road report.
- 9) Schedule public hearing on Commissioner's agenda and prepare notice. DATE 3/10/98
- 10) Publish public hearing notice one time. DATE 3-5-98

- 11) Send a copy of the viewing committee report and public hearing notice to the following:
 - Persons listed in #7
 - County Road Superintendent
 - County Attorney
 - County Commissioners (3 copies)

- 12) Prepare affidavit of mailing for petition file (regarding the viewers report).
- 13) Commissioners hold public hearing to grant or deny petition.
- 14) County Attorney drafts resolution for Commissioners to consider at next public hearing.
- 15) Commissioners pass resolution
- 16) Within 10 days of passage of resolution send copies of resolution to all persons listed in #7 (BY CERTIFIED MAIL)
- 17) Type affidavit of mailing for petition file (regarding the boards decision).
- 18) If the petition is granted, a certified copy of the resolution must be recorded.

State of Montana

County of Gallatin

Bozeman



March 3, 1998

Board of County Commissioners
Gallatin County Courthouse
Bozeman, MT 59715

RE: abandonment of a road easement described in Film 95 Page 4557 of the records of the Gallatin County Clerk and Recorder which is located in the S1/2 of Section 5, T1N, R7E.

Dear Board,

On February 20, 1998, the undersigned, being appointed as viewing committee, viewed the area described above which has been petitioned to be abandoned as described in Road Petition #784.

We observed the location of the easement from the west while on Bridger Canyon Road, (State Highway 86) and from the east while on Brackett Creek Road. The easement has not been constructed.

According to the petition, this easement was granted to assist in completing projects planned by the Montana Department of Transportation and Gallatin County in 1987. Since that time both the state and county have replaced bridges and the original project has been abandoned.

It does not appear that anyone would become land-locked nor access denied to public lands if the abandonment were granted.

Sincerely,

A handwritten signature in cursive script, appearing to read "Phil Olson", written over a horizontal line.

Phil Olson, County Commissioner

A handwritten signature in cursive script, appearing to read "Shelley Vance", written over a horizontal line.

Shelley Vance, Clerk and Recorder/Surveyor

A handwritten signature in cursive script, appearing to read "Sam Gianfrancesco", written over a horizontal line.

Sam Gianfrancesco, County Road Superintendent

NOTICE OF PUBLIC HEARING

NOTICE IS HEREBY GIVEN that a petition to abandon a road easement has been submitted to the Board of County Commissioners of Gallatin County, Montana, for consideration.

Petitioners are requesting that the road easement described in the records of the Gallatin County Clerk and Recorder on Film 95 Page 4557 and located in the S1/2 of Section 5, T1N, R7E be abandoned. The easement is located north of the intersection of Bridger Canyon Road (State Highway 86) and Brackett Creek Road.

NOTICE IS FURTHER GIVEN that the Board of Gallatin County Commissioners will conduct a public hearing on March 10, 1998, at 1:30 P.M., in the Community Room, 3rd Floor of the Gallatin County Courthouse, 311 W. Main, Bozeman, Montana, at which time public opinion may be heard. All interested parties are encouraged to attend.

Further information may be obtained from Gallatin County Commissioners Phil Olson, Jane Jelinski, or Bill Murdock, 311 W. Main, Room 301, Bozeman, Montana 59715, telephone 582-3000.

Dated this 3 day of March, 1998.



Shelley Vance
Clerk and Recorder
Gallatin County, Montana

State of Montana

County of Gallatin

Bozeman



AFFIDAVIT OF MAILING

STATE OF MONTANA)
)ss
COUNTY OF GALLATIN)

SHELLEY VANCE, BEING FIRST DULY SWORN ON OATH, deposes and says:

That she is the duly elected, qualified and acting County Clerk and Recorder of Gallatin County, Montana.

I hereby certify that copies of the attached notice of public hearing and viewing committee report were mailed to all signers of the petition; landowners named on the petition; individuals named in the petition who could be affected; the postmaster of the area; and the Public Lands Access Association on March 4, 1998.

Shelley Vance

Shelley Vance
Clerk and Recorder
Gallatin County, Montana

AFFIDAVIT OF MAILING

**STATE OF MONTANA)
)ss
COUNTY OF GALLATIN)**

SHELLEY VANCE, BEING FIRST DULY SWORN ON OATH, deposes and says:

That she is the duly elected, qualified and acting County Clerk and Recorder of Gallatin County, Montana.

I hereby certify that copies of Resolution 1998-19 to abandon county road, an easement to modify the Brackett Creek Road were mailed to all signers of the petition; landowners named on the petition; individuals named in the petition who could be affected; the postmaster of the area; and the Public Lands Access Association on March 12, 1998.

A handwritten signature in cursive script that reads "Shelley Vance".

Shelley Vance
Clerk and Recorder
Gallatin County, Montana

Stacy - please insert these minutes into the daily log agenda of the Commissioners' for Thursday, January 29, 1998

A special meeting was called to order by Chairman Jelinski at 3:30 p.m. Also present were Commissioners Bill Murdock and Phil Olson, Deputy County Attorney Susan Swimley, and Clerk and Recorder Shelley Vance. Mrs. Vance submitted a petition to abandon a portion of road easement located at the junction of Bridger Canyon Road and Brackett Creek Road within Section 5, Township 1 North, Range 7 East. She reported that the petition contains the signatures of at least 10 qualified freeholders within Gallatin County. Motion by Bill Murdock to accept the petition. Seconded by Phil Olson. None voting nay. Motion carried. Chairman Jelinski appointed Road Superintendent Sam Gianfrancisco, Commissioner Phil Olson, and Clerk and Recorder Shelley Vance as the viewing committee.

(oops!)

There being no further business
the meeting adjourned at 3:35 p.m.

Brackett
Cr. Rd.



160880

FILM 95 PAGE 4557

State of Mont., County of Gallatin. ss Filed for record February 10, 19 87
at 10:35 A.M. and recorded in Book 95 of MISCELLANEOUS page 4557

Gerald R. Wain Recorder. By Shelley M. Cheney Deputy

Rt: Gallatin County EASEMENT
Road Office

\$-0-

THIS INDENTURE, MADE THE 9th day of February 1987 A.D.
between HAMMERSMARK RANCH Co. party of the first part
and Gallatin County, a political subdivision of the State of Montana,
party of the second part;

WITNESSETH:

The party of the first part does hereby grant, dedicate, convey
and confirm unto the party of the second part an easement and right-of-way
located in the County of Gallatin, State of Montana, hereinafter described
to-wit:

A strip of land eighty (80) feet wide on the north side
and sixty (60) feet wide on the south side of a center
line being more particularly described as follows: Beginning
at a point on the easterly right of way line of Federal
Aid Project F-86-1(9)18, radial from center line station
106+12 said point being N 17°32'03" W, 179.16 feet from
the South ¼ corner of Section 5, Township One North Range
Seven East (T1N,R7E) PMM, Gallatin County, Montana: Thence
along a 150 feet radius curve to the right thru a delta
of 34°46'21" for 91.03 feet; thence South 61°04'20" East
a distance of 50.00 feet; thence along a 250 foot radius
curve to the left thru a delta of 38°32'15" for 168.15
feet; thence North 80°23'25" East a distance of 137.26
feet; thence North 80°39'08" East a distance of 367.12
feet; thence North 83°15'29" East a distance of 227.09
feet to a point on the center line of the Brackett Creek
Road.

The said right-of-way hereby granted is for construction, repair,
maintenance and operation of a common, public highway known as Brackett
Creek Road, without any reservation or exceptions whatsoever by the
party of the first part with respect to the construction, repair
or maintenance, operation or control or otherwise of the full width
of said right-of-way or of any road which may be constructed upon
said right-of-way. The party of the first part does also hereby
dedicate the said right-of-way to the general public for all road
and highway purposes provided for in the laws of the State of Montana,
including the right of use for surface and subsurface utilities. Provided
if, at any time hereafter, the use of said right-of-way shall be
abandoned by the properly consituted authorities in such matters
for all purposes as a public road, as provided by statute, then
said easement covered by said right-of-way shall revert to the said
party of the first part, its successors or assigns, except for that
right granted for utilities.

IN WITNESS WHEREOF, the said party of the first part has executed
this agreement the day and year first written.

Hammersmark Ranch Co.
Tom E Hammersmark Pres.
Dorothy A. Hammersmark Sec.

Subscribed and sworn to before
me this 9th day of February, 1987
Dianne Gibby
Notary Public for State of Montana
Residing at: Big Timber
Commission expires 7-15-89

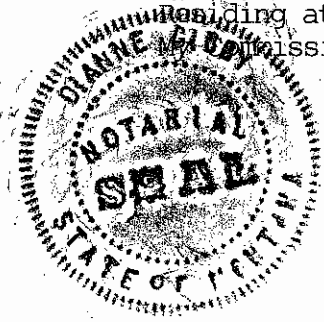

RESOLUTION NO. 1998 - 22
A RESOLUTION DISCLAIMING INTEREST IN
GOVERNMENT LAND OFFICE ROAD EASEMENTS IN
SECTION 5, TOWNSHIP 1 NORTH, RANGE 7 EAST,
GALLATIN COUNTY, MONTANA

WHEREAS, the 1908-1909 Government Land Office (GLO) map in Section 5, Township 1 North, Range 7 East, Gallatin County, Montana, P.M.M. shows three (3) roads, two of which run in the general direction of the existing Bridger Canyon Road, also known as State Highway 86, and one of which runs in the general direction of the existing Brackett Creek Road, which roads are shown on Exhibit A in the black bold lines and marked "GLO Roads" for further clarity; and

WHEREAS, a review of the Gallatin County Road records shows that the road easements appearing on the GLO map are not now and have not for many years been used as roads; and

WHEREAS, said road easements were not established under applicable Montana law prior to the withdrawal of said Section from the public domain.

NOW, THEREFORE BE IT RESOLVED:

The Gallatin County Commission disclaims any interest in these three (3) road easements shown on the 1908-1909 GLO map in Section 5, Township 1 North, Range 7 East, P.M.M., in Gallatin County, Montana, depicted in black bold lines and marked "GLO Roads" on the map attached hereto and incorporated herein as Exhibit A.

DATED this 17th day of March, 1998.

BOARD OF COUNTY COMMISSIONERS OF
GALLATIN COUNTY

Jane Jelinski
Jane Jelinski, Chairman

Phil Olson
Phil Olson, Member

William A. Murdock
William A. Murdock, Member

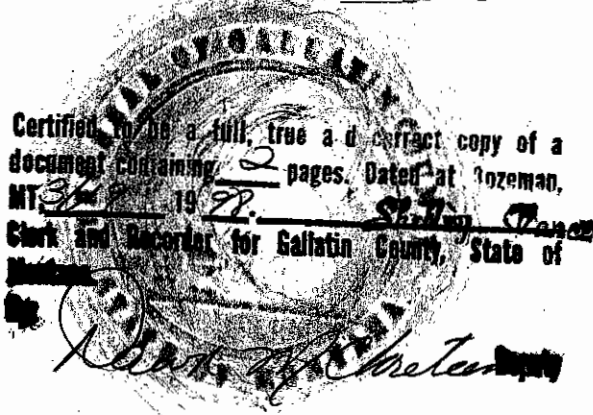

ATTEST:

Shelley Vance
SHELLEY VANCE
Clerk and Recorder

Exhibit A
(Section 5-T1N/R7E)

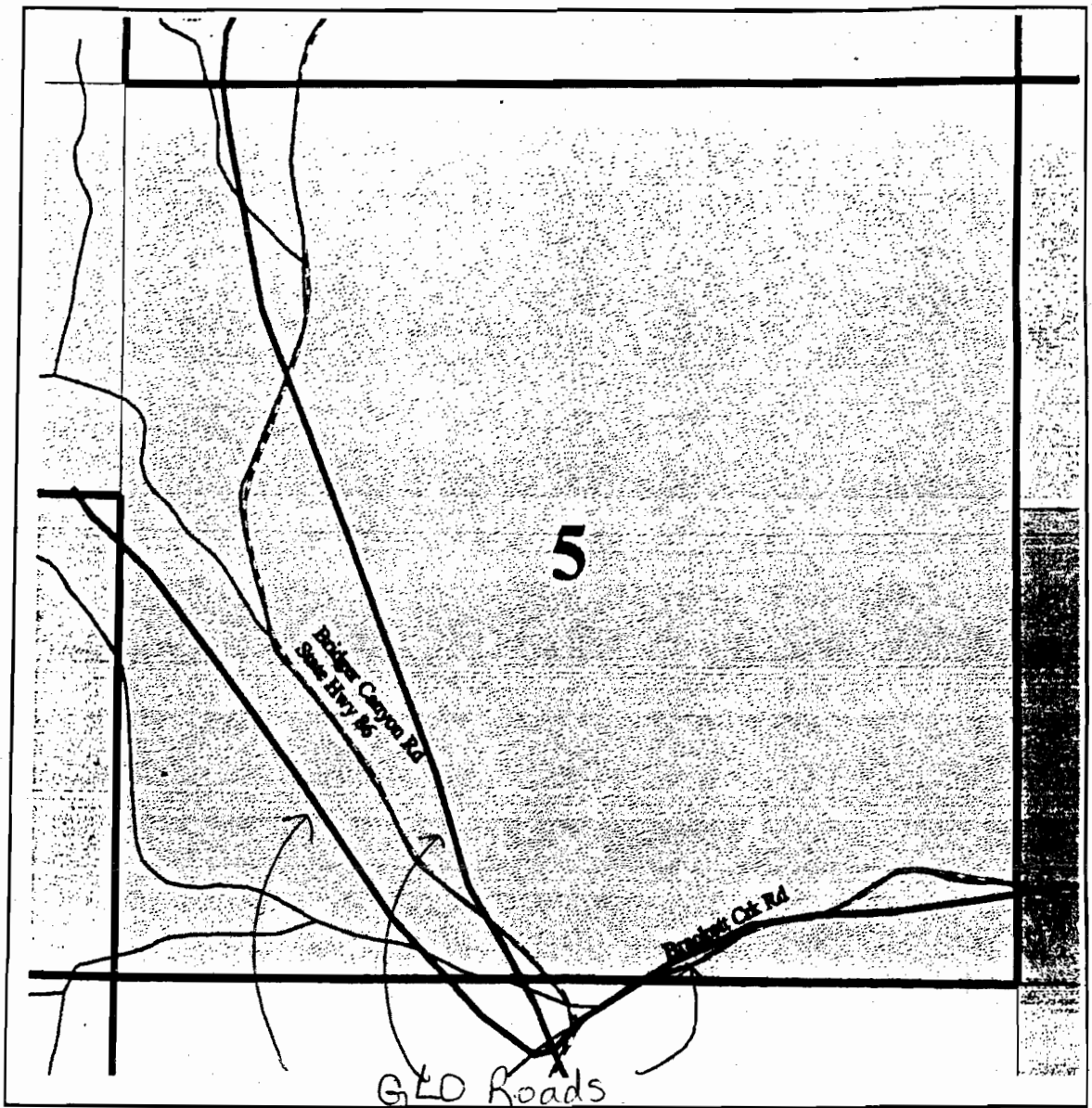

GLO roads mapped Aug 1, 1908 - Sept. 23, 1909. The GLO roads mapped here are superimposed on existing road locations mapped by Gallatin County using GPS. Differences in the mapped location could possibly be a result of relocation of the road over time. Though we can only speculate, it is more likely the difference results from different map sources and scales.

The historic maps appear to be more generalized, and there was no information on the mapping methods they used.

Phone conversation with Nancy Halstrom, Bozeman Ranger District, USFS 12/9/97 indicated that she believed State Highway 86 had not been relocated since the easement was granted in 1956. She had no additional GLO information and stated that the courthouse record was the best record available.

INDEXED 96
PLATTED 25

361470

THIS INSTRUMENT WAS FILED FOR RECORD IN THIS OFFICE ON
THE 19TH DAY OF MARCH, A.D., 19 98
AT 2:07 P.M., AND WAS DULY RECORDED IN BOOK 182
OF MISCELLANEOUS RECORDS, PAGE 3230

OFFICE OF COUNTY RECORDER)
COUNTY OF GALLATIN)
STATE OF MONTANA)

Fee \$ -0-
RT: FILED

Shelley Vance

RECORDER. BY *Duffy J. May* DEPUTY

RESOLUTION NO. 1998 - 19

**DECISION CONCERNING PETITION TO ABANDON COUNTY ROAD,
AN EASEMENT TO MODIFY THE BRACKET CREEK ROAD**

WHEREAS, a Petition to Abandon County Road was filed requesting to abandon a road easement described on Film 95, Page 4557 of records of the Gallatin County Clerk and Recorder which is located in the S 1/2 of Section 5, T1N, R7E, Gallatin County, Montana. The easement is located north of the intersection of Bridger Canyon Road (State Highway 86) and Brackett Creek Road.

WHEREAS, the Gallatin County Clerk and Recorder reported to the Gallatin County Commissioners that the petition contained sufficient signatures as required by Section 7-14-2601, MCA; and

WHEREAS, the Gallatin County Commissioners appointed a committee consisting of one county commissioner, the county surveyor and the road supervisor to investigate the feasibility and desirability of abandoning the road; and

WHEREAS, on March 10, 1998, the Gallatin County Commissioners conducted a public hearing, after notice on the petition and the results of the investigation.

WHEREAS, the Gallatin County Commissioners voted unanimously to grant the petition and abandon that portion of the road easement described in Film 95, Page 4557 of the records of the Gallatin County Clerk and Recorder which is located in the S 1/2 of Section 5, T1N, R7E, Gallatin County, Montana.

NOW, THEREFORE BE IT RESOLVED:

1. Based on the petition, results of the investigation and information presented at the public hearing on March 10, 1998, the Gallatin County Commissioners conclude that the decision made herein is in the best interests of the county.

2. The following road as requested in the Petition to Abandon County Road is abandoned:

That portion of the road easement described in Film 95, Page 4557 of the records of the Gallatin County Clerk and Recorder which is located in the S 1/2 of Section 5, T1N, R7E, Gallatin County, Montana.

3. Within ten (10) days from the date that this resolution is adopted the Clerk and Recorder shall send a copy of this resolution by certified mail to all owners of land abutting on the road. The owners shall be those listed on the last county assessment roll.

4. The Clerk and Recorder shall notify the county road supervisor by furnishing a certified copy of this resolution to the supervisor.

DATED this 10th day of March, 1998.

BOARD OF COUNTY COMMISSIONERS OF GALLATIN COUNTY

Jane Jelinski
Jane Jelinski, Chairman

Phil Olson
Phil Olson, Member

William A. Mardock
William A. Mardock, Member

ATTEST:

Shelley Vance
SHELLEY VANCE
Clerk and Recorder

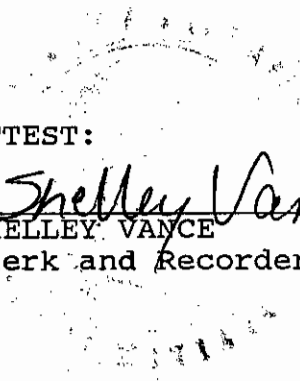

INDEXED
PLATED

360962

State of Mont., County of Gallatin. ss Filed for record March 11, 19 98
at 4:40 P M., and recorded in Book 182 of MISCELLANEOUS page 2135
Shelley Vance Recorder. By David M. Peterson Deputy

RT: ROAD PETITION #784
FEE: \$0

Certified to be a full, true and correct copy of a document containing 2 pages. Dated at Bozeman, MT, 3/11 19 98. Shelley Vance Clerk and Recorder for Gallatin County, State of Montana.
By David M. Peterson Deputy

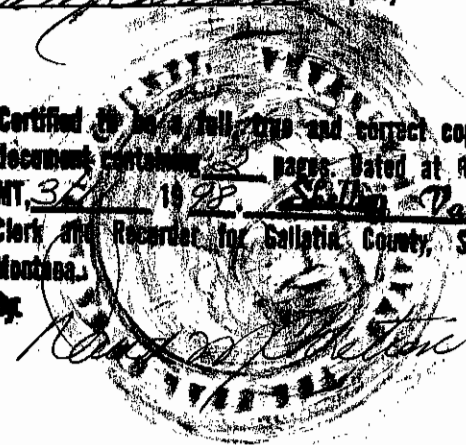

SENDER:

- Complete items 1 and/or 2 for additional services.
- Complete items 3, 4a, and 4b.
- Print your name and address on the reverse of this form so that we can return this card to you.
- Attach this form to the front of the mailpiece, or on the back if space does not permit.
- Write "Return Receipt Requested" on the mailpiece below the article number.
- The Return Receipt will show to whom the article was delivered and the date delivered.

3. Article Addressed to:
Postmaster
Bozeman, MT 59771

4a. Article Number
P 787 055 116

4b. Service Type
 Registered
 Express Mail
 Return Receipt for Merchandise
 COD

7. Date of Delivery
3/13/98

5. Received By: (Print Name)
[Signature]

6. Signature: (Addressee or Agent)
X *[Signature]*

PS Form 3811, December 1994 102595-97-B-0179 Domestic Return Receipt

Thank you for using Return Receipt Service.

Is your RETURN ADDRESS completed on the reverse side?

- Complete items 1 and/or 2 for additional services.
- Complete items 3, 4a, and 4b.
- Print your name and address on the reverse of this form so that we can return this card to you.
- Attach this form to the front of the mailpiece, or on the back if space does not permit.
- Write "Return Receipt Requested" on the mailpiece below the article number.
- The Return Receipt will show to whom the article was delivered and the date delivered.

3. Article Addressed to:
Public Land Access Assoc.
270 Bill Fairhurst
3rd. Ave. East
Bozeman, MT 59752

4a. Article Number
P 787 055 115

4b. Service Type
 Registered
 Express Mail
 Return Receipt for Merchandise
 COD

7. Date of Delivery
3-13-98

5. Received By: (Print Name)

6. Signature: (Addressee or Agent)
X *[Signature]*

PS Form 3811, December 1994 102595-97-B-0179 Domestic Return Receipt

Thank you for using Return Receipt Service.

Is your RETURN ADDRESS completed on the reverse side?

SENDER:

- Complete items 1 and/or 2 for additional services.
- Complete items 3, 4a, and 4b.
- Print your name and address on the reverse of this form so that we can return this card to you.
- Attach this form to the front of the mailpiece, or on the back if space does not permit.
- Write "Return Receipt Requested" on the mailpiece below the article number.
- The Return Receipt will show to whom the article was delivered and the date delivered.

3. Article Addressed to:
Gerald R. Wine
216 Bison Trail
Bozeman, MT 59718

4a. Article Number
P 787 055 122

4b. Service Type
 Registered
 Express Mail
 Return Receipt for Merchandise
 COD

7. Date of Delivery
3/13

5. Received By: (Print Name)

6. Signature: (Addressee or Agent)
X *[Signature]*

PS Form 3811, December 1994 102595-97-B-0179 Domestic Return Receipt

Thank you for using Return Receipt Service.

Is your RETURN ADDRESS completed on the reverse side?

- Complete items 1 and/or 2 for additional services.
- Complete items 3, 4a, and 4b.
- Print your name and address on the reverse of this form so that we can return this card to you.
- Attach this form to the front of the mailpiece, or on the back if space does not permit.
- Write "Return Receipt Requested" on the mailpiece below the article number.
- The Return Receipt will show to whom the article was delivered and the date delivered.

3. Article Addressed to:
Judith A Salvas
46 Sundance Trail
Bozeman, MT 59718

4a. Article Number
P 787 055 124

4b. Service Type
 Registered
 Express Mail
 Return Receipt for Merchandise
 COD

7. Date of Delivery
3-13

5. Received By: (Print Name)

6. Signature: (Addressee or Agent)
X *[Signature]*

PS Form 3811, December 1994 102595-97-B-0179 Domestic Return Receipt

Thank you for using Return Receipt Service.

Is your RETURN ADDRESS completed on the reverse side?

SENDER:
 Complete items 1 and/or 2 for additional services.
 Complete items 3, 4a, and 4b.
 Print your name and address on the reverse of this form so that we can return this card to you.
 Attach this form to the front of the mailpiece, or on the back if space does not permit.
 Write "Return Receipt Requested" on the mailpiece below the article number.
 The Return Receipt will show to whom the article was delivered and the date delivered.

I also wish to receive the following services (for an extra fee):
 1. Addressee's Address
 2. Restricted Delivery
 Consult postmaster for fee.

3. Article Addressed to:
 Charlotte Hansen
 9424 Cougar Dr.
 Bozeman, Mt 59718

4a. Article Number
 P 787 055 126

4b. Service Type
 Registered
 Express Mail
 Return Receipt for Merchandise
 Certified
 Insured
 COD

7. Date of Delivery
 3-16-98

8. Addressee's Address (Only if requested and fee is paid)

5. Received By: (Print Name)
 Charlotte Hansen

6. Signature: (Addressee or Agent)
 X *Charlotte Hansen*

PS Form 3811, December 1994 102595-97-B-0179 Domestic Return Receipt

SENDER:
 Complete items 1 and/or 2 for additional services.
 Complete items 3, 4a, and 4b.
 Print your name and address on the reverse of this form so that we can return this card to you.
 Attach this form to the front of the mailpiece, or on the back if space does not permit.
 Write "Return Receipt Requested" on the mailpiece below the article number.
 The Return Receipt will show to whom the article was delivered and the date delivered.

I also wish to receive the following services (for an extra fee):
 1. Addressee's Address
 2. Restricted Delivery
 Consult postmaster for fee.

3. Article Addressed to:
 David M. Johnson
 Box 1601
 Bozeman, MT 59771

4a. Article Number
 P 787 055 113

4b. Service Type
 Registered
 Express Mail
 Return Receipt for Merchandise
 Certified
 Insured
 COD

7. Date of Delivery
 3/16

8. Addressee's Address (Only if requested and fee is paid)

5. Received By: (Print Name)

6. Signature: (Addressee or Agent)
 X *David M. Johnson*

PS Form 3811, December 1994 102595-97-B-0179 Domestic Return Receipt

SENDER:
 Complete items 1 and/or 2 for additional services.
 Complete items 3, 4a, and 4b.
 Print your name and address on the reverse of this form so that we can return this card to you.
 Attach this form to the front of the mailpiece, or on the back if space does not permit.
 Write "Return Receipt Requested" on the mailpiece below the article number.
 The Return Receipt will show to whom the article was delivered and the date delivered.

I also wish to receive the following services (for an extra fee):
 1. Addressee's Address
 2. Restricted Delivery
 Consult postmaster for fee.

3. Article Addressed to:
 Sue Frye
 360 Evening Star Lane
 Bozeman, MT 59715

4a. Article Number
 P 787 055 123

4b. Service Type
 Registered
 Express Mail
 Return Receipt for Merchandise
 Certified
 Insured
 COD

7. Date of Delivery
 3-16-98

8. Addressee's Address (Only if requested and fee is paid)

5. Received By: (Print Name)

6. Signature: (Addressee or Agent)
 X *Sue Frye*

PS Form 3811, December 1994 102595-97-B-0179 Domestic Return Receipt

SENDER:
 Complete items 1 and/or 2 for additional services.
 Complete items 3, 4a, and 4b.
 Print your name and address on the reverse of this form so that we can return this card to you.
 Attach this form to the front of the mailpiece, or on the back if space does not permit.
 Write "Return Receipt Requested" on the mailpiece below the article number.
 The Return Receipt will show to whom the article was delivered and the date delivered.

I also wish to receive the following services (for an extra fee):
 1. Addressee's Address
 2. Restricted Delivery
 Consult postmaster for fee.

3. Article Addressed to:
 Katie J. Lang
 8605 Ricky Dr.
 Bozeman, Mt 59718

4a. Article Number
 P 787 055 125

4b. Service Type
 Registered
 Express Mail
 Return Receipt for Merchandise
 Certified
 Insured
 COD

7. Date of Delivery
 3-16-98

8. Addressee's Address (Only if requested and fee is paid)

5. Received By: (Print Name)

6. Signature: (Addressee or Agent)
 X *Katie J. Lang*

PS Form 3811, December 1994 102595-97-B-0179 Domestic Return Receipt

is your RETURN ADDRESS completed on the reverse side?

is your RETURN ADDRESS completed on the reverse side?

Thank you for using Return Receipt Service.

Thank you for using Return Receipt Service.

Is your RETURN ADDRESS completed on the reverse side?

SENDER:

- Complete items 1 and/or 2 for additional services.
- Complete items 3, 4a, and 4b.
- Print your name and address on the reverse of this form so that we can return this card to you.
- Attach this form to the front of the mailpiece, or on the back if space does not permit.
- Write "Return Receipt Requested" on the mailpiece below the article number.
- The Return Receipt will show to whom the article was delivered and the date delivered.

I also wish to receive the following services (for an extra fee):

- 1. Addressee's Address
- 2. Restricted Delivery

Consult postmaster for fee.

3. Article Addressed to:

Marilyn Shrader
15233 Brackett Creek Rd.
Bozeman, MT 59771

4a. Article Number

P 787 055 112

4b. Service Type

- Registered Certified
- Express Mail Insured
- Return Receipt for Merchandise COD

7. Date of Delivery

5. Received By: (Print Name)

6. Signature: (Addressee or Agent)

X *Marilyn Shrader*

8. Addressee's Address (Only if requested and fee is paid)

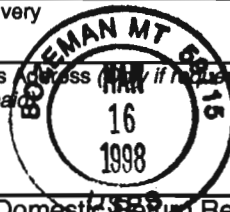

PS Form 3811, December 1994

102595-97-B-0179

Domestic Return Receipt

Thank you for using Return Receipt Service.

Is your RETURN ADDRESS completed on the reverse side?

SENDER:

- Complete items 1 and/or 2 for additional services.
- Complete items 3, 4a, and 4b.
- Print your name and address on the reverse of this form so that we can return this card to you.
- Attach this form to the front of the mailpiece, or on the back if space does not permit.
- Write "Return Receipt Requested" on the mailpiece below the article number.
- The Return Receipt will show to whom the article was delivered and the date delivered.

I also wish to receive the following services (for an extra fee):

- 1. Addressee's Address
- 2. Restricted Delivery

Consult postmaster for fee.

3. Article Addressed to:

Hammersmark Ranch Co.
P.O. Box 2529
Billings, MT 59103

4a. Article Number

P 787 055 114

4b. Service Type

- Registered Certified
- Express Mail Insured
- Return Receipt for Merchandise COD

7. Date of Delivery

5. Received By: (Print Name)

6. Signature: (Addressee or Agent)

X *Jess C. Miller*

8. Addressee's Address (Only if requested and fee is paid)

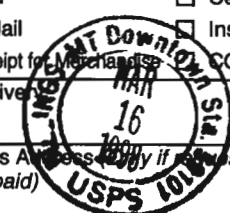

PS Form 3811, December 1994

102595-97-B-0179

Domestic Return Receipt

Thank you for using Return Receipt Service.

Is your RETURN ADDRESS completed on the reverse side?

SENDER:

- Complete items 1 and/or 2 for additional services.
- Complete items 3, 4a, and 4b.
- Print your name and address on the reverse of this form so that we can return this card to you.
- Attach this form to the front of the mailpiece, or on the back if space does not permit.
- Write "Return Receipt Requested" on the mailpiece below the article number.
- The Return Receipt will show to whom the article was delivered and the date delivered.

I also wish to receive the following services (for an extra fee):

- 1. Addressee's Address
- 2. Restricted Delivery

Consult postmaster for fee.

3. Article Addressed to:

Pam Grover
8461 Lupine Lane
Bozeman, MT 59718

4a. Article Number

P 787 055 121

4b. Service Type

- Registered Certified
- Express Mail Insured
- Return Receipt for Merchandise COD

7. Date of Delivery

3-17-98

5. Received By: (Print Name)

6. Signature: (Addressee or Agent)

X *Pam Grover*

8. Addressee's Address (Only if requested and fee is paid)

PS Form 3811, December 1994

Domestic Return Receipt

Thank you for using Return Receipt Service.