

Field house road

No. 622

PETITIONER:

R. R. Renne, John Martin et al.

Petition filed ..... 191

Viewers appointed ..... Sept. 11 1957

Report filed ..... Sept. 11, 1957

Date of hearing ..... Sept. 25 1957

Report approved ..... Sept. 25 1957

Order of survey ..... 191

Surveyed by M.S.C. ..... 191

Field Book No. .... Page

Recorded in Roadbook ..... 191

Declared County Road ..... 191

Approved: ..... Chairman

See Book 32 ..... Commissioners' Proceedings,

pages 541, 548 & 554

County Clerk

PETITION FOR ROAD

NO. 682

To the Honorable Board of  
County Commissioners of  
Gallatin County, Montana

Gentlemen:

We, the undersigned freeholders of Gallatin County, taxable therein for road purposes, do hereby petition your Honorable Body to establish as a County Road the following described road:

Beginning at the center of Section 13, T.2S., R.5E.; thence south 1/4 mile, thence east 1/2 mile to the County Road No. 205, known as Third Avenue South road, at a point 1/4 mile south of the East quarter section corner of said Section 13. Said corner being the intersection of Third Avenue and Lincoln Street.

Said road is to be 60 feet wide, being 30 feet on either side of the north and south center line of Section 13. Total length of proposed road is 3/4 mile.

| <u>NAME OF PETITIONER</u>      | <u>ADDRESS OF PETITIONER</u>   |
|--------------------------------|--------------------------------|
| <u>R.R. Remond</u> ✓           | <u>RFD 2 Bozeman</u>           |
| <u>John W. Martin</u> ✓        | <u>RFD 2 Bozeman</u>           |
| <u>Mary W. Remond</u>          | <u>Route 2 Bozeman</u>         |
| <u>Edwin E. Richter</u>        | <u>Route 2 Bozeman</u>         |
| <u>Martha L. Hawksworth</u>    | <u>Sourdough Road, Bozeman</u> |
| <u>Bernard Lamb</u> ✓          | <u>Ranch 2</u>                 |
| <u>James F. Nickerson</u> ✓    | <u>R#2 BZN</u>                 |
| <u>Quasata B. Nickerson</u> ✓  | <u>Rto #2 Bozeman</u>          |
| <u>Arlene Hirschler</u>        | <u>Sourdough Rd. Bozeman</u>   |
| <u>W. P. Finckel</u> ✓         | <u>Sourdough Road</u>          |
| <u>John R. Jensen</u> ✓        | <u>Sourdough Road</u>          |
| <u>Lois W. Jensen</u> ✓        | <u>Sourdough Road</u>          |
| <u>Leth C. Emery</u> ✓         | <u>Sourdough Road</u>          |
| <u>Mrs. Pearl Ruth Pelburn</u> | <u>Sourdough Road</u>          |
| <u>Nicholas Helburn</u>        | <u>" " "</u>                   |
| <u>Annie May Figgins</u>       | <u>RFD 2 Bozeman</u>           |

FOR PETITIONERS WHO PROPOSE DONATING GRATUITOUSLY THE RIGHT OF WAY

\_\_\_\_\_1957

We, the undersigned, in full consideration for benefits received or to accrue to us, do hereby agree to, and by these presents do gratuitously donate to Gallatin County, Montana, a right-of-way through any and all lands owned by us along the line of the proposed road hereinbefore petitioned for, the route of same to be definitely determined by the County.

The said donation is to take effect and be of full force immediately when (and only when) said proposed road shall be open to the public throughout its full length.

LAND OWNED BY SAME

| NAME OF DONOR                                      | DESCRIPTION     | SEC. | TWP. | RANGE |
|--|-----------------|------|------|-------|
| Montana State College<br>(Wife) By RR Renne, Pres. | SE <sup>4</sup> | 13   | 25   | 5E    |
| (Wife) _____                                       |                 |      |      |       |
| Annie May Figgins ✓<br>(Wife) _____                | SE <sup>4</sup> | 13   | 25   | 5E    |
| (Wife) _____                                       |                 |      |      |       |
| (Wife) _____                                       |                 |      |      |       |
| (Wife) _____                                       |                 |      |      |       |
| (Wife) _____                                       |                 |      |      |       |

To the Board of County  
Commissioners of  
Gallatin County, Montana

Gentlemen:

I do here-by certify that the undersigned, with one exception, and  
that being Nicholas Helburn, are freeholders of Gallatin County.

| <u>NAME OF PETITIONER</u>                     | <u>ADDRESS OF PETITIONER</u>                           |
|---|--|
| 1 R. R. Renne                                 | Route 2, Bozeman, Montana                              |
| 2 John H. Martin                              | Route 2, Bozeman, Montana                              |
| 3 Mary A. Renne                               | Route 2, Bozeman, Montana                              |
| 4 Helen E. Fechter                            | Route 2, Bozeman, Montana                              |
| 5 Martha L. Hawksworth                        | Route 2, Bozeman, Montana                              |
| 6 Bernice Lamb                                | Route 2, Bozeman, Montana                              |
| 7 James Nickerson                             | Route 2, Bozeman, Montana                              |
| 8 Arlene Hirschler                            | Route 2, Bozeman, Montana                              |
| 9 D. Hirschler                                | Route 2, Bozeman, Montana                              |
| 10 Don K. Jensen                              | Route 2, Bozeman, Montana                              |
| 11 Lois M. Jensen                             | Route 2, Bozeman, Montana                              |
| 12 Beth C. Emery                              | Route 2, Bozeman, Montana                              |
| 13 Mrs. Tesa Loth Helburn<br>Nicholas Helburn | Route 2, Bozeman, Montana<br>Route 2, Bozeman, Montana |
| 14 Annie May Figgins                          | Route 2, Bozeman, Montana                              |
| 15 Juanita B. Nickerson                       | Route 2, Bozeman, Montana                              |

Chas. Bonner  
assessor

NOTICE OF HEARING UPON PETITION FOR ESTABLISHING COUNTY ROAD NO. 622  
BETWEEN THE POINTS DESCRIBED IN THE PETITION FILED HEREIN.

YOU ARE HEREBY NOTIFIED That a meeting of the Board of County Commissioners of Gallatin County, Montana, will be held in the office of the said County Commissioners at the Courthouse in the City of Bozeman, County of Gallatin, State of Montana, on the 25th day of Sept. A.D. 1957, at Nine (9) o'clock A.M., of said day, to consider the Petition filed for the establishing of County Road No. 622, between the points described in said Petition. Beginning at the center of Section 13, T2S, R5E; thence south 1/4 mile, thence east 1/2 mile to the County Road No. 205, known as Third Avenue South road, at a point 1/4 mile south of the East quarter section corner of said Section 13, said corner being the intersection of Third Avenue and Lincoln Street. Said road to be 3/4 mile long and 60 feet wide.

You are further notified that if you have any objections to the establishing of said road, as petitioned, you may appear at the time and place as above given and present your objections to the Board of County Commissioners of Gallatin County, State of Montana, at that time and place. Dated at Bozeman, Montana this 18th day of Sept. A.D. 1957.

BOARD OF COUNTY COMMISSIONERS OF  
GALLATIN COUNTY, STATE OF MONTANA

By

*George L. Stucky*  
Chairman

# memo

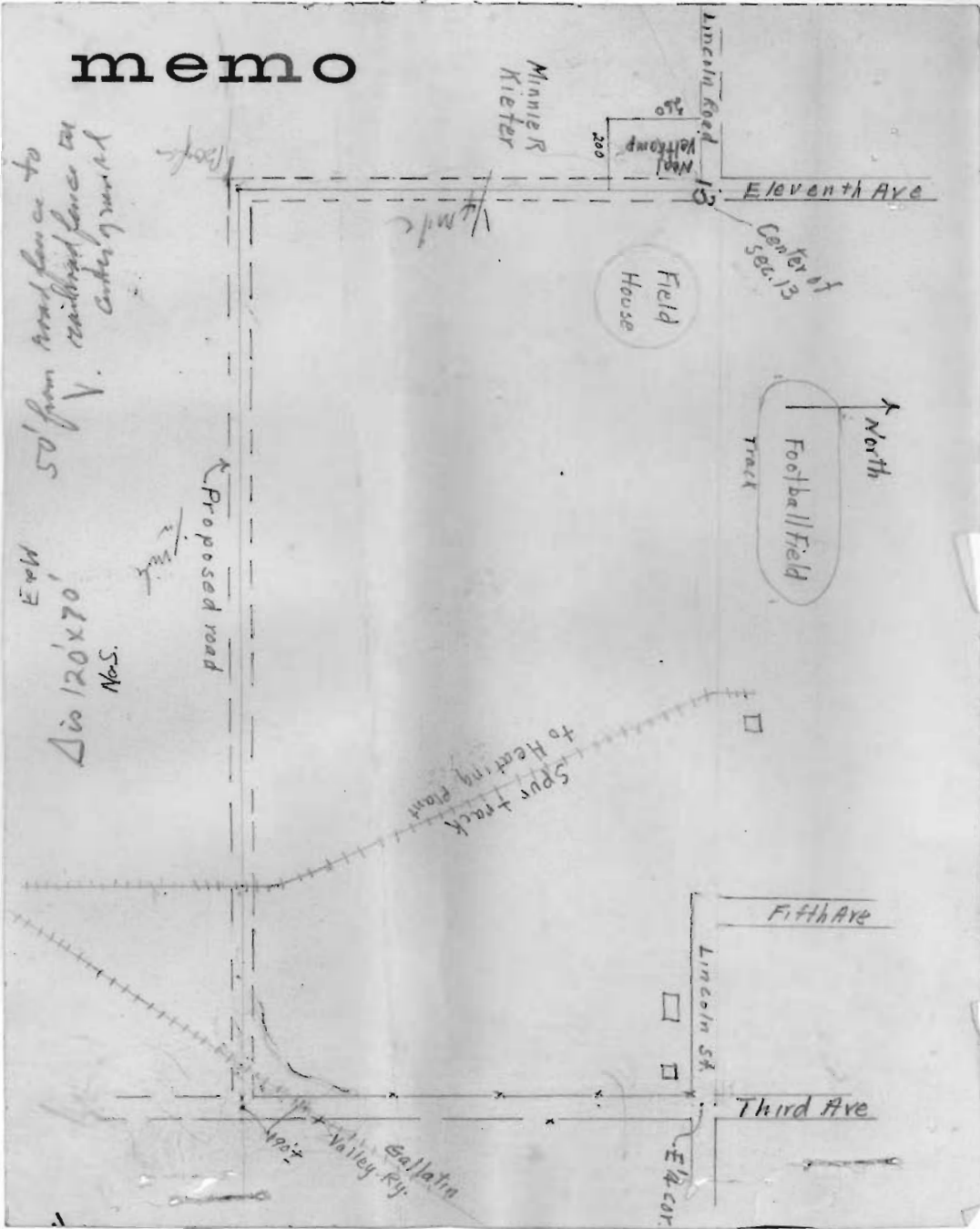

No 434930

RECEIPT FOR CERTIFIED MAIL—15¢

|  |                     |
|--|---------------------|
| SENT TO<br><b>Mr. Don K. Jensen</b>  | POSTMARK<br>OR DATE |
| STREET AND NO.<br><b>Route #2</b>  |                     |
| CITY AND STATE<br><b>Bozeman, Montana</b>  |                     |
| If you want a return receipt, check which<br><input type="checkbox"/> 7¢ shows to whom and when delivered<br><input type="checkbox"/> 31¢ shows to whom, when, and address where delivered |                     |

POD Form 3800 Apr. 1955

No 434931

RECEIPT FOR CERTIFIED MAIL—15¢

|  |                     |
|--|---------------------|
| SENT TO<br><b>Mrs. Lois M. Jensen</b>  | POSTMARK<br>OR DATE |
| STREET AND NO.<br><b>Route #2</b>  |                     |
| CITY AND STATE<br><b>Bozeman, Montana</b>  |                     |
| If you want a return receipt, check which<br><input type="checkbox"/> 7¢ shows to whom and when delivered<br><input type="checkbox"/> 31¢ shows to whom, when, and address where delivered |                     |

POD Form 3800 Apr. 1955

RECEIPT FOR CERTIFIED MAIL—15¢

|  |                     |
|--|---------------------|
| SENT TO<br><b>Mr. D. Hirschler</b>   | POSTMARK<br>OR DATE |
| STREET AND NO.<br><b>Route #2</b>  |                     |
| CITY AND STATE<br><b>Bozeman, Montana</b>  |                     |
| If you want a return receipt, check which<br><input type="checkbox"/> 7¢ shows to whom and when delivered<br><input type="checkbox"/> 31¢ shows to whom, when, and address where delivered |                     |

POD Form 3800 Apr. 1955

No 434932

No 434928

RECEIPT FOR CERTIFIED MAIL—15¢

|  |                     |
|--|---------------------|
| SENT TO<br><b>Mrs. Tesa Loth Helburn</b>   | POSTMARK<br>OR DATE |
| STREET AND NO.<br><b>Route #2</b>  |                     |
| CITY AND STATE<br><b>Bozeman, Montana</b>  |                     |
| If you want a return receipt, check which<br><input type="checkbox"/> 7¢ shows to whom and when delivered<br><input type="checkbox"/> 31¢ shows to whom, when, and address where delivered |                     |

POD Form 3800 Apr. 1955

No 434935

RECEIPT FOR CERTIFIED MAIL—15¢

|  |                     |
|--|---------------------|
| SENT TO<br><b>Mrs. Annie May Figgins</b>   | POSTMARK<br>OR DATE |
| STREET AND NO.<br><b>Route #2</b>  |                     |
| CITY AND STATE<br><b>Bozeman, Montana</b>  |                     |
| If you want a return receipt, check which<br><input type="checkbox"/> 7¢ shows to whom and when delivered<br><input type="checkbox"/> 31¢ shows to whom, when, and address where delivered |                     |

POD Form 3800 Apr. 1955

RECEIPT FOR CERTIFIED MAIL—15¢

|  |                     |
|--|---------------------|
| SENT TO<br><b>Miss Martha L. Hawksworth</b>  | POSTMARK<br>OR DATE |
| STREET AND NO.<br><b>Route #2</b>  |                     |
| CITY AND STATE<br><b>Bozeman, Mont.</b>  |                     |
| If you want a return receipt, check which<br><input type="checkbox"/> 7¢ shows to whom and when delivered<br><input type="checkbox"/> 31¢ shows to whom, when, and address where delivered |                     |

POD Form 3800 Apr. 1955

No 434927

RECEIPT FOR CERTIFIED MAIL—15¢

|  |                     |
|--|---------------------|
| SENT TO<br><b>Mrs. Mary A. Renne</b>   | POSTMARK<br>OR DATE |
| STREET AND NO.<br><b>Route #2</b>  |                     |
| CITY AND STATE<br><b>Bozeman, Mont.</b>  |                     |
| If you want a return receipt, check which<br><input type="checkbox"/> 7¢ shows to whom and when delivered<br><input type="checkbox"/> 31¢ shows to whom, when, and address where delivered |                     |

POD Form 3800 Apr. 1955

No 434940

No 434933

RECEIPT FOR CERTIFIED MAIL—15¢

|  |                     |
|--|---------------------|
| SENT TO<br><b>Mrs. Arlene Hirschler</b>  | POSTMARK<br>OR DATE |
| STREET AND NO.<br><b>Route #2</b>  |                     |
| CITY AND STATE<br><b>Bozeman, Montana</b>  |                     |
| If you want a return receipt, check which<br><input type="checkbox"/> 7¢ shows to whom and when delivered<br><input type="checkbox"/> 31¢ shows to whom, when, and address where delivered |                     |

POD Form 3800 Apr. 1955

N<sup>o</sup> 434934

RECEIPT FOR CERTIFIED MAIL—15¢

|  |                     |
|--|---------------------|
| SENT TO<br><b>Dr. R. R. Renne</b>  | POSTMARK<br>OR DATE |
| STREET AND NO.<br><b>Route #2</b>  |                     |
| CITY AND STATE<br><b>Bozeman, Mont.</b>  |                     |
| If you want a return receipt, check which <input type="checkbox"/> 7¢ shows to whom and when delivered <input type="checkbox"/> 31¢ shows to whom, when, and address where delivered |                     |

POD Form 3800 Apr. 1955

N<sup>o</sup> 434926

RECEIPT FOR CERTIFIED MAIL—15¢

|   |                     |
|---|---------------------|
| SENT TO<br><b>Mrs. Juanita B. Nickerson</b>   | POSTMARK<br>OR DATE |
| STREET AND NO.<br><b>Route #2</b>   |                     |
| CITY AND STATE<br><b>Bozeman, Montana</b>   |                     |
| If you want a return receipt, check which <input checked="" type="checkbox"/> 7¢ shows to whom and when delivered <input type="checkbox"/> 31¢ shows to whom, when, and address where delivered |                     |

POD Form 3800 Apr. 1955

N<sup>o</sup> 434941

RECEIPT FOR CERTIFIED MAIL—15¢

|  |                     |
|--|---------------------|
| SENT TO<br><b>Mr. James Nickerson</b>  | POSTMARK<br>OR DATE |
| STREET AND NO.<br><b>Route #2</b>  |                     |
| CITY AND STATE<br><b>Bozeman, Montana</b>  |                     |
| If you want a return receipt, check which <input type="checkbox"/> 7¢ shows to whom and when delivered <input type="checkbox"/> 31¢ shows to whom, when, and address where delivered |                     |

POD Form 3800 Apr. 1955

N<sup>o</sup> 434939

RECEIPT FOR CERTIFIED MAIL—15¢

|  |                     |
|--|---------------------|
| SENT TO<br><b>Miss Helen E. Fechter</b>  | POSTMARK<br>OR DATE |
| STREET AND NO.<br><b>Route #2</b>  |                     |
| CITY AND STATE<br><b>Bozeman, Montana</b>  |                     |
| If you want a return receipt, check which <input type="checkbox"/> 7¢ shows to whom and when delivered <input type="checkbox"/> 31¢ shows to whom, when, and address where delivered |                     |

POD Form 3800 Apr. 1955

N<sup>o</sup> 434937

RECEIPT FOR CERTIFIED MAIL—15¢

|  |                     |
|--|---------------------|
| SENT TO<br><b>Miss Bernice Lamb</b>  | POSTMARK<br>OR DATE |
| STREET AND NO.<br><b>Route #2</b>  |                     |
| CITY AND STATE<br><b>Bozeman, Montana</b>  |                     |
| If you want a return receipt, check which <input type="checkbox"/> 7¢ shows to whom and when delivered <input type="checkbox"/> 31¢ shows to whom, when, and address where delivered |                     |

POD Form 3800 Apr. 1955

N<sup>o</sup> 434936

RECEIPT FOR CERTIFIED MAIL—15¢

|  |                     |
|--|---------------------|
| SENT TO<br><b>Dr. R. R. Renne Pres.</b>  | POSTMARK<br>OR DATE |
| STREET AND NO.<br><b>Montana State College</b>   |                     |
| CITY AND STATE<br><b>Bozeman, Montana</b>  |                     |
| If you want a return receipt, check which <input type="checkbox"/> 7¢ shows to whom and when delivered <input type="checkbox"/> 31¢ shows to whom, when, and address where delivered |                     |

POD Form 3800 Apr. 1955

RECEIPT FOR CERTIFIED MAIL—15¢

|  |                     |
|--|---------------------|
| SENT TO<br><b>Mrs. Beth C. Emery</b>   | POSTMARK<br>OR DATE |
| STREET AND NO.<br><b>Route #2</b>  |                     |
| CITY AND STATE<br><b>Bozeman, Montana</b>  |                     |
| If you want a return receipt, check which <input type="checkbox"/> 7¢ shows to whom and when delivered <input type="checkbox"/> 31¢ shows to whom, when, and address where delivered |                     |

POD Form 3800 Apr. 1955

N<sup>o</sup> 434929

RECEIPT FOR CERTIFIED MAIL—15¢

|  |                     |
|--|---------------------|
| SENT TO<br><b>Mr. John H. Martin</b>   | POSTMARK<br>OR DATE |
| STREET AND NO.<br><b>Route #2</b>  |                     |
| CITY AND STATE<br><b>Bozeman, Montana</b>  |                     |
| If you want a return receipt, check which <input type="checkbox"/> 7¢ shows to whom and when delivered <input type="checkbox"/> 31¢ shows to whom, when, and address where delivered |                     |

POD Form 3800 Apr. 1955

N<sup>o</sup> 434938



DELIVERING EMPLOYEE  Deliver ONLY to addressee.  
 Show address where delivered.

Received from the postmaster the registered, certified, or insured article, the number of which appears on the face of this return receipt.

1. \_\_\_\_\_  
(Signature or name of addressee)

2. \_\_\_\_\_  
(Signature of addressee's agent—Agent should enter addressee's name on line ONE above)

Date of Delivery **SEP 19 1957**

DELIVERING EMPLOYEE  Deliver ONLY to addressee.  
 Show address where delivered.

Received from the postmaster the registered, certified, or insured article, the number of which appears on the face of this return receipt.

1. \_\_\_\_\_  
(Signature or name of addressee)

2. \_\_\_\_\_  
(Signature of addressee's agent—Agent should enter addressee's name on line ONE above)

Date of Delivery **SEP 19 1957**

DELIVERING EMPLOYEE  Deliver ONLY to addressee.  
 Show address where delivered.

Received from the postmaster the registered, certified, or insured article, the number of which appears on the face of this return receipt.

1. \_\_\_\_\_  
(Signature or name of addressee)

2. \_\_\_\_\_  
(Signature of addressee's agent—Agent should enter addressee's name on line ONE above)

Date of Delivery \_\_\_\_\_

DELIVERING EMPLOYEE  Deliver ONLY to addressee.  
 Show address where delivered.

Received from the postmaster the registered, certified, or insured article, the number of which appears on the face of this return receipt.

1. \_\_\_\_\_  
(Signature or name of addressee)

2. *Geo J. Herman*  
(Signature of addressee's agent—Agent should enter addressee's name on line ONE above)

Date of Delivery **SEP 19 1957**

DELIVERING EMPLOYEE  Deliver ONLY to addressee.  
 Show address where delivered.

Received from the postmaster the registered, certified, or insured article, the number of which appears on the face of this return receipt.

1. \_\_\_\_\_  
(Signature or name of addressee)

2. \_\_\_\_\_  
(Signature of addressee's agent—Agent should enter addressee's name on line ONE above)

Date of Delivery **SEP 19 1957**

DELIVERING EMPLOYEE  Deliver ONLY to addressee.  
 Show address where delivered.

Received from the postmaster the registered, certified, or insured article, the number of which appears on the face of this return receipt.

1. \_\_\_\_\_  
(Signature or name of addressee)

2. \_\_\_\_\_  
(Signature of addressee's agent—Agent should enter addressee's name on line ONE above)

Date of Delivery **SEP 19 1957**

DELIVERING EMPLOYEE  Deliver ONLY to addressee.  
 Show address where delivered.

Received from the postmaster the registered, certified, or insured article, the number of which appears on the face of this return receipt.

1. \_\_\_\_\_  
(Signature or name of addressee)

2. Maryanne Rohrbach  
(Signature of addressee's agent—Agent should enter addressee's name on line ONE above)

Date of Delivery \_\_\_\_\_  
SEP 19 1957

☆ U. S. GOVERNMENT PRINTING OFFICE : 1955 16-71548-1

DELIVERING EMPLOYEE  Deliver ONLY to addressee.  
 Show address where delivered.

Received from the postmaster the registered, certified, or insured article, the number of which appears on the face of this return receipt.

1. \_\_\_\_\_  
(Signature or name of addressee)

2. [Signature]  
(Signature of addressee's agent—Agent should enter addressee's name on line ONE above)

Date of Delivery \_\_\_\_\_  
SEP 19 1957

☆ U. S. GOVERNMENT PRINTING OFFICE : 1955 16-71548-1

DELIVERING EMPLOYEE  Deliver ONLY to addressee.  
 Show address where delivered.

Received from the postmaster the registered, certified, or insured article, the number of which appears on the face of this return receipt.

1. Mrs. Lois M. Jensen  
(Signature or name of addressee)

2. \_\_\_\_\_  
(Signature of addressee's agent—Agent should enter addressee's name on line ONE above)

Date of Delivery \_\_\_\_\_  
SEP 19 1957

☆ U. S. GOVERNMENT PRINTING OFFICE : 1955 16-71548-1

DELIVERING EMPLOYEE  Deliver ONLY to addressee.  
 Show address where delivered.

Received from the postmaster the registered, certified, or insured article, the number of which appears on the face of this return receipt.

1. Lon Z. Jensen  
(Signature or name of addressee)

2. \_\_\_\_\_  
(Signature of addressee's agent—Agent should enter addressee's name on line ONE above)

Date of Delivery \_\_\_\_\_  
SEP 19 1957

☆ U. S. GOVERNMENT PRINTING OFFICE : 1955 16-71548-1

INSTRUCTIONS TO DELIVERING EMPLOYEE

- DELIVER ONLY TO ADDRESSEE (20¢ additional)  
 SHOW ADDRESS WHERE DELIVERED IN ITEM 4 BELOW (31¢ additional)

RECEIPT

Received from the Postmaster the Registered, Certified, or Insured Article, the number of which appears on the face of this return receipt.

1. SIGNATURE OR NAME OF ADDRESSEE  
X Quanta B. Ruberson
2. SIGNATURE OF ADDRESSEE'S AGENT (Agent should enter addressee's name in item 1 above)
3. DELIVERY DATE 9/19/57
4. \_\_\_\_\_

CO-16-71548-3 GPO

DELIVERING EMPLOYEE  Deliver ONLY to addressee.  
 Show address where delivered.

Received from the postmaster the registered, certified, or insured article the number of which appears on the face of this return receipt.

1. James Nielsen  
(Signature or name of addressee)
2. \_\_\_\_\_  
(Signature of addressee's agent—Agent should enter addressee's name on line ONE above)

Date of Delivery 9/19/57

☆ U. S. GOVERNMENT PRINTING OFFICE : 1955 16-71548-1

DELIVERING EMPLOYEE  Deliver ONLY to addressee.  
 Show address where delivered.

Received from the postmaster the registered, certified, or insured article, the number of which appears on the face of this return receipt.

1. Alan E. Gochter  
(Signature or name of addressee)

2. \_\_\_\_\_  
(Signature of addressee's agent—Agent should enter addressee's name on line ONE above)

Date of Delivery SEP 24 1957

DELIVERING EMPLOYEE  Deliver ONLY to addressee.  
 Show address where delivered.

Received from the postmaster the registered, certified, or insured article, the number of which appears on the face of this return receipt.

1. Bernice L...  
(Signature or name of addressee)

2. \_\_\_\_\_  
(Signature of addressee's agent—Agent should enter addressee's name on line ONE above)

Date of Delivery SEP 19 1957

DELIVERING EMPLOYEE  Deliver ONLY to addressee.  
 Show address where delivered.

Received from the postmaster the registered, certified, or insured article, the number of which appears on the face of this return receipt.

1. RR Runne  
(Signature or name of addressee)

2. C L Diamond  
(Signature of addressee's agent—Agent should enter addressee's name on line ONE above)

Date of Delivery SEP 19 1957

DELIVERING EMPLOYEE  Deliver ONLY to addressee.  
 Show address where delivered.

Received from the postmaster the registered, certified, or insured article, the number of which appears on the face of this return receipt.

1. Mrs. Lee Emery  
(Signature or name of addressee)

2. \_\_\_\_\_  
(Signature of addressee's agent—Agent should enter addressee's name on line ONE above)

Date of Delivery \_\_\_\_\_

DELIVERING EMPLOYEE  Deliver ONLY to addressee.  
 Show address where delivered.

Received from the postmaster the registered, certified, or insured article, the number of which appears on the face of this return receipt.

1. \_\_\_\_\_  
(Signature or name of addressee)

2. \_\_\_\_\_  
(Signature of addressee's agent—Agent should enter addressee's name on line ONE above)

Date of Delivery \_\_\_\_\_