

No. 604

PETITIONER:

Thos. Veltkamp, Jas. Border et al

Petition filed Nov. 10 1953  
to close Roads No. 170, No. 483 & No. 214

Viewers appointed Nov. 10 1953

Report filed Nov. 11 1953

Date of hearing 10:20 AM Dec. 12 1953

Report approved 191

Order of survey 191

Surveyed 191

Field Book No. Page

Recorded in Roadbook 191

Declared County Road 191

Approved: Chairman

See Book 30 Commissioners' Proceedings,  
pages 374-375

County Clerk

To the Honorable Board of  
 County Commissioners of  
 Gallatin County, Montana

Gentlemen:

We, the undersigned freeholders of Gallatin  
 County, do hereby petition your Honorable body to  
 abandon as a public highway, the following described  
 County Road:

That portion of County Roads No. 214, No.483  
 and No.170 as follows: Beginning at the Northwest corner  
 of Section 22, T.3 N., R.4 E; thence East  $\frac{1}{2}$  mile, thence  
 Southerly and southeasterly thru Sections 22, 27, 34,  
 35, T.3 N., R.4 E. and Section 2, T.2 N., R.4 E. to the  
 Dry Creek Road, at a point in the Northeast Quarter  
 of said Section 2, said point being approximately  
 $\frac{1}{2}$  mile north of the Accola Elevator. Total distance,  
 4.71 miles.

NAMES OF PETITIONERS

- |     |   |   |                          |           |   |                      |          |
|-----|---|---|--------------------------|-----------|---|----------------------|----------|
| OK  | ✓ | ✓ | Thomas Veltkamp          | Manhattan | ✓ | Richard E. Andrus    | Belg     |
| OK  | ✓ | ✓ | S. F. McDonnell          | Manhattan | ✓ | Manhattan Company    | Man      |
| OK  | ✓ | ✓ | Harry Brainard           | Manhattan | ✓ | Manhattan            | Belgrade |
| OK  | ✓ | ✓ | J. H. Bolder Corporation | Belgrade  | ✓ | Roy Callantine       | Belgrade |
| OK  | ✓ | ✓ | Joe Morgan               | Belgrade  | ✓ | Esther M. Collins    | Belgrade |
| OK  | ✓ | ✓ | G. W. Hamilton           | Belgrade  | ✓ | M. M. Benson         | Belgrade |
| OK  | ✓ | ✓ | Wesley Brownell          | Belgrade  | ✓ | Mrs. Evelyn Veltkamp | Man      |
| OK  | ✓ | ✓ | Steve Miller             | Belgrade  | ✓ | James Veltkamp       | "        |
| Man | ✓ | ✓ | William D. Brainard      |           | ✓ | Aileen Veltkamp      | "        |
| "   | ✓ | ✓ | Walter Brainard          |           | ✓ | Cecelia McDonnell    | Man      |
| OK  | ✓ | ✓ | C. E. Brainard           |           |   |                      |          |

# GALLATIN COUNTY



## MONTANA

GEORGE L. STUCKY - - COMMISSIONER  
C. W. CRAMER - - - COMMISSIONER  
ALLEN T. HARGROVE - - COMMISSIONER  
EARL WALTON - - CLERK AND RECORDER  
C. A. MacKENZIE - - - TREASURER  
MRS. GRACE ROSNESS - - - AUDITOR  
~~PHILIP EVANS~~ - - - ASSESSOR

Viola F. Hull

W. W. LESSLEY - - - DISTRICT JUDGE  
MRS. EVELYN THOMPSON CLERK OF COURT  
MICHAEL J O'CONNELL - - - ATTORNEY  
C. E. RICE - - - - - SHERIFF  
MRS. MARTHA HAYNES - SUP'T OF SCHOOLS  
WALT DAVIS - - - PUBLIC ADMINISTRATOR  
DR. CARL W. HAMMER - - HEALTH OFFICER

BOZEMAN, MONTANA

January 8, 1953

I hereby certify that I have checked the signers on the attached petition and find that they are all freholders except the following:

William D. Brainard  
Walter Brainard and  
Richard Andrus.

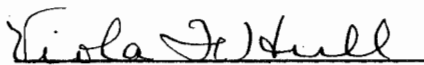
  
Viola F. Hull  
County Assessor

GALLATIN COUNTY  
MONTANA

GEORGE L. STUCKY - - COMMISSIONER  
C. W. CRAMER - - - COMMISSIONER  
ALLEN T. HARGROVE - COMMISSIONER  
EARL WALTON - CLERK AND RECORDER  
C. A. MacKENZIE - - - TREASURER  
MRS. GRACE ROSNESS - - AUDITOR  
PHIL E. EVANS - - - ASSESSOR

W. W. LESSLEY - - - DISTRICT JUDGE  
MRS. EVELYN THOMPSON CLERK OF COURT  
MICHAEL J O'CONNELL - ATTORNEY  
C. E. RICE - - - - - SHERIFF  
MRS. MARTHA HAYNES - SUP'T OF SCHOOLS  
WALT DAVIS - - - PUBLIC ADMINISTRATOR  
DR. CARL W. HAMMER - - HEALTH OFFICER

BOZEMAN, MONTANA

Nov. 11th, 1953

To the Honorable Board of  
County Commissioners of  
Gallatin County,  
Gentlemen:

As Acting County Surveyor viewing Roads No. 170  
No. 483 and part of No. 214 at the request of the County  
Commissioners of Gallatin County on Nov. 11th 1953, ~~we~~ make  
the following Comments:

" Mr. Allen Hargrove, myself and Jim Border Jr.  
went over the road in Border's jeep. We left the Dry Creek  
Road and entered on road No 170, in Section 22 T 2 N R 4 E,  
then on Road No. 483 in Section 35 and 34, T 3 N R 4 E; I ~~w~~  
note the road has had very little travel on it for approx-  
imately one and one half miles; From there on it showed more  
travel, some of which was farm machinery, as there is a  
stubble field on the west side of the road in question.  
Continuing on north across the County Road which runs west  
from Menard, we enter on road No. 214; this also showed very  
little sign of travel all the way untill you get to the  
Northwest corner of Section 22, T 3 N. R 4 E.

In regard to fences, referring to the map, there was  
a gate as you go into Section 35 and as you leave Section 35.  
The rest of the way fences were down and wire scattered over  
the ground, except on the North where the road is adjacent  
to Border's and Durhams land in Section 22.

At no place along this route has there been any County  
Road maintenance for a number of years. There are no bridges  
or culverts in useable condition, except a stock pass between  
Sections 2 and 35. "

  
Allen T. Hargrove, Commissioner

W. C. Papke Acting Co. Surveyor

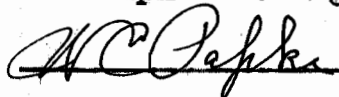

# GALLATIN COUNTY

## MONTANA

GEORGE L. STUCKY - - COMMISSIONER  
C. W. CRAMER - - - COMMISSIONER  
ALLEN T. HARGROVE - COMMISSIONER  
EARL WALTON - CLERK AND RECORDER  
C. A. MacKENZIE - - - TREASURER  
MRS. GRACE ROSNESS - - AUDITOR  
PHIL E. EVANS - - - ASSESSOR

W. W. LESSLEY - - DISTRICT JUDGE  
MRS. EVELYN THOMPSON CLERK OF COURT  
MICHAEL J O'CONNELL - ATTORNEY  
C. E. RICE - - - - SHERIFF  
MRS. MARTHA HAYNES - SUP'T OF SCHOOLS  
WALT DAVIS - - PUBLIC ADMINISTRATOR  
DR. CARL W. HAMMER - - HEALTH OFFICER

BOZEMAN, MONTANA

Dec. 4, 1953

The following list of names and addresses of parties or land owners whose property is adjacent to that portion of Road No. 214, Road No, 483 and No, 170 which has been petitioned to be closed , as follows:

Section 15, Twp 3 north, range 4 East,- William E. Durham,  
whose address is Belgrade, R. F. D.  
and Sec. 35

Section 22,/Twp. 3 North, Range 4 East, J. H. Border Corp.  
Address, - Belgrade R. F. D.

Section 22, T 3 N. R 4 East, S. F. & Cecelia Mc Donnell,  
Address, - Three Forks, R. F. D.

Section 27 and 34, T 3 N. R 4 East, James Veltkamp, Et al,  
Address, - Manhattan, R F D.

Section 2 Twp. 2 North, Range 4 East, Ralph A. Biggs,  
Address, Belgrade, R F D.

# GALLATIN COUNTY

## MONTANA

GEORGE L. STUCKY - - COMMISSIONER  
C. W. CRAMER - - - COMMISSIONER  
ALLEN T. HARGROVE - COMMISSIONER  
EARL WALTON - - - CLERK AND RECORDER  
C. A. MacKENZIE - - - TREASURER  
MRS. GRACE ROSNESS - - AUDITOR  
PHIL E. EVANS - - - - ASSESSOR

W. W. LESSLEY - - - DISTRICT JUDGE  
MRS. EVELYN THOMPSON CLERK OF COURT  
MICHAEL J O'CONNELL - - ATTORNEY  
C. E. RICE - - - - - SHERIFF  
MRS. MARTHA HAYNES - SUP'T OF SCHOOLS  
WALT DAVIS - - - PUBLIC ADMINISTRATOR  
DR. CARL W. HAMMER - - HEALTH OFFICER

BOZEMAN, MONTANA

600

S. F. McDonnell ✓

*Ther York*

Cecelia McDonnell ✓

" "

James Veltkamp ✓

Manhattan

Eileen Veltkamp ✓

"

Thomas Veltkamp ✓

"

Evelyn Veltkamp ✓

"

Harold Veltkamp ✓

"

Arlene Veltkamp ✓

Manhattan

J. H. Border, Corporation ✓

*Belgrade*

William B. Durham ✓

Belgrade

Ralph A. Biggs.

Belgrade

Petitioners

Sent Registered Mail to:

- ✓ - ✓ Thomas Veltkamp, Manhattan
- ✓ - ✓ S. F. McDonnell, Manhattan
- ✓ - ✓ J. H. Border, Belgrade
- ✓ - ✓ Joe Morgan, Belgrade
- ✓ - ✓ G. W. Hamilton, Belgrade
- ✓ - ✓ Wesley Brownell, Belgrade
- ✓ - ✓ Steve Miller, Belgrade
- ✓ - ✓ William D. Brainard, Maudlow
- ✓ - ✓ Walter Brainard, Maudlow
- ✓ - ✓ C. E. Brainard, Maudlow
- ✓ - ✓ Adjacent land owners
- ✓ - ✓ Mr. Ralph Biggs Belgrade
- ✓ - ✓ Mr. William E. Durham Belgrade

- ✓ - Richard E. Andrus, Belgrade
- ✓ - Maynard Sinton, Manhattan
- ✓ - Francis Durham, Belgrade
- ✓ - Roy Callantine, Maudlow
- ✓ - Etta M. Collins, Belgrade
- ✓ - M. M. Benson, Belgrade
- ✓ - Mrs. Evelyn Veltkamp, Manhattan
- ✓ - James Veltkamp, Manhattan
- ✓ - Aileen Veltkamp, Manhattan
- ✓ - Cecelia McDonnell, Manhattan
- ✓ - Harry Brainard, Maudlow

December 4, 1953

Dear Sir:

This is to notify you that the Board of County Commissioners has accepted the report of the Board of Viewers on Road Petition No. 604 on the following described County roads.

That portion of County Roads No. 214, No. 483, and No. 170 described as follows: Beginning at the Northwest (NW) corner of Section Twenty-two (22), Township Three (3) North, Range Four (4) East: thence East one-half mile; thence Southerly and Southeasterly through Sections Twenty-two (22), Twenty-seven (27), Thirty-four (34) Thirty-five (35), Township Three North, Range Four (4), East, and Section Two (2), Township Two (2) North, Range Four (4) East to the Dry Creek road at a point in the Northeast Quarter (NE $\frac{1}{4}$ ) of said Section Two (2), said point being approximately one-half mile North of the Accola Elevator, a total distance of 4.71 miles.

Hearing on the above matter will be held by the Board of County Commissioners at ten o'clock A. M. on the 12th day of December, 1953, at the Court House in Bozeman, Montana, at which time the Commissioners will determine the merits of said matter finally, and, at which time all persons interested may make objections or offer suggestions relative to the abandonment of said highway.

Yours very truly

\_\_\_\_\_  
County Clerk & Recorder

Registered mail - return receipt required

Send to same group as in letter of December 4, 1953

December 15, 1953

After much discussion and weighing of evidence since the hearing of Road Petition #608, it was unanimously decided to close roads #214, No. 483 and No. 170, as of December 14, 1953.

There was no evidence produced to show that these roads were needed for public convenience.

Yours very truly

---

---

Board of County Commissioners  
of Gallatin County

GLS:EP



R E S O L U T I O N

BE IT HEREBY RESOLVED, That after weighing evidence presented at road closing hearing, December 12, 1953 it is the unanimous decision of this Board to close the roads represented by Petition No. 603, described as follows:

That portion of County roads No. 214, No. 483 and No. 170 described as follows: Beginning at the Northwest (NW) corner of Section Twenty-two (22), Township Three (3) North, Range Four (4) East; thence East one-half mile; thence Southerly and Southeasterly through Sections Twenty-two, (22) Twenty-seven (27), Thirty-four (34), Thirty-five (35) Township Three (3) North, Range Four (4) East, and Section Two (2), Township Two (2) North, Range Four (4) East, to the Dry Creek Road at a point in the Northeast Quarter (NE $\frac{1}{4}$ ) of Said Section Two (2), said point being approximately one-half mile North of the Accola Elevator, a total distance of 4.71 miles; and

WHEREAS, There was never at any time sufficient evidence to prove these roads necessary for public convenience; and

WHEREAS, if these roads were to be left open it could be a terrific, unnecessary expense to the County to put same in shape to be traveled by modern vehicles; and

WHEREAS, there was no evidence to show or prove that these roads have been maintained as public roads for many years,

THEREFORE, BE IT FURTHER RESOLVED, That these roads represented by Petition No. 603, be closed as public roads, effective this date.

DATED this 14th day of December, A.D., 1953.

George L. Stucky  
C. W. Cramer  
Allen J. Hargrove  
Board of County Commissioners of  
Gallatin County

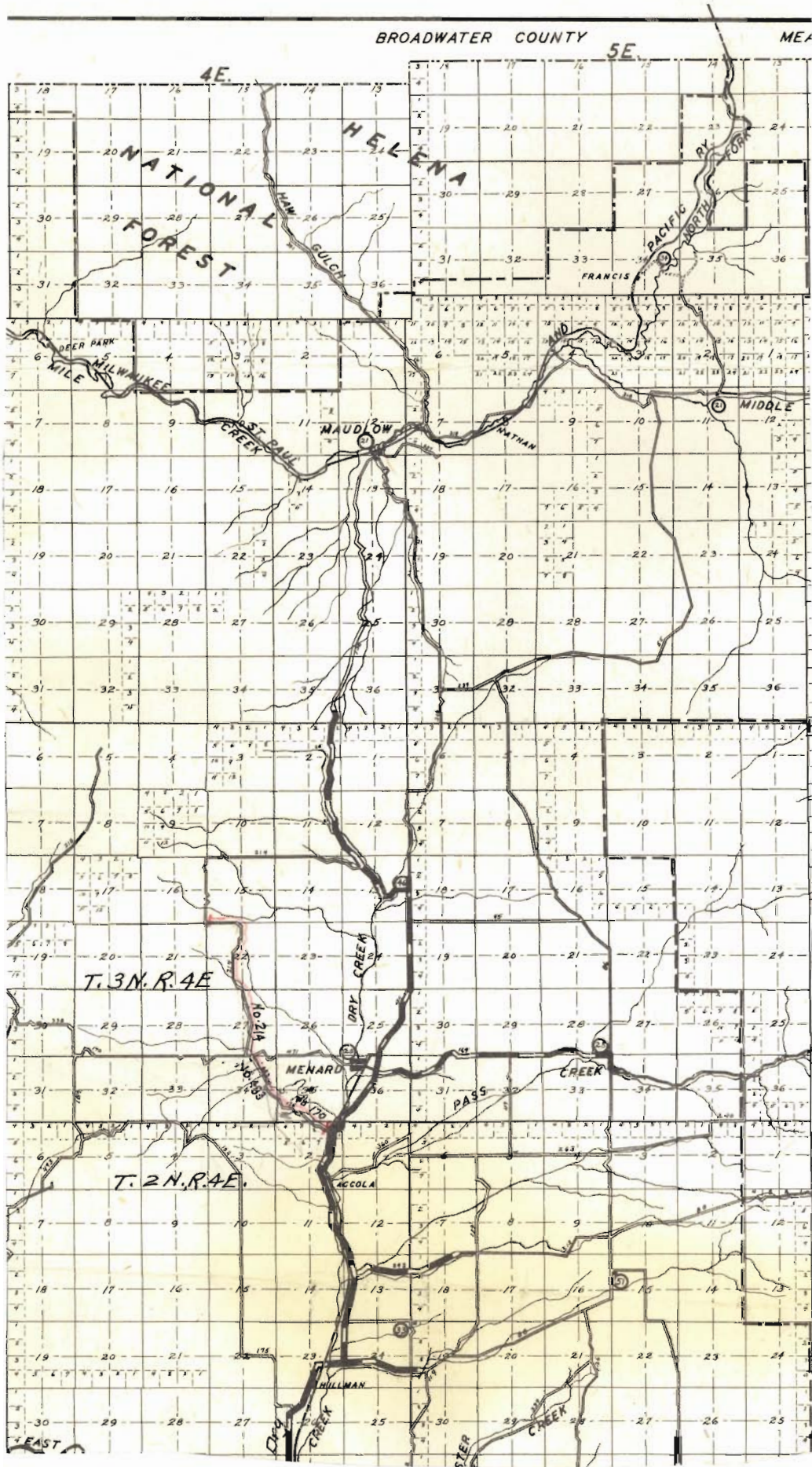

Portion of Roads No. 241, No 483 & No 170

Viewed Nov 11, 1953  
Papke & Hargrove  
Jim Border Jr. Jeep driver

Map for Road  
No. 241

Township No. 3 No. 3 N. Range No. 4 E Mer.

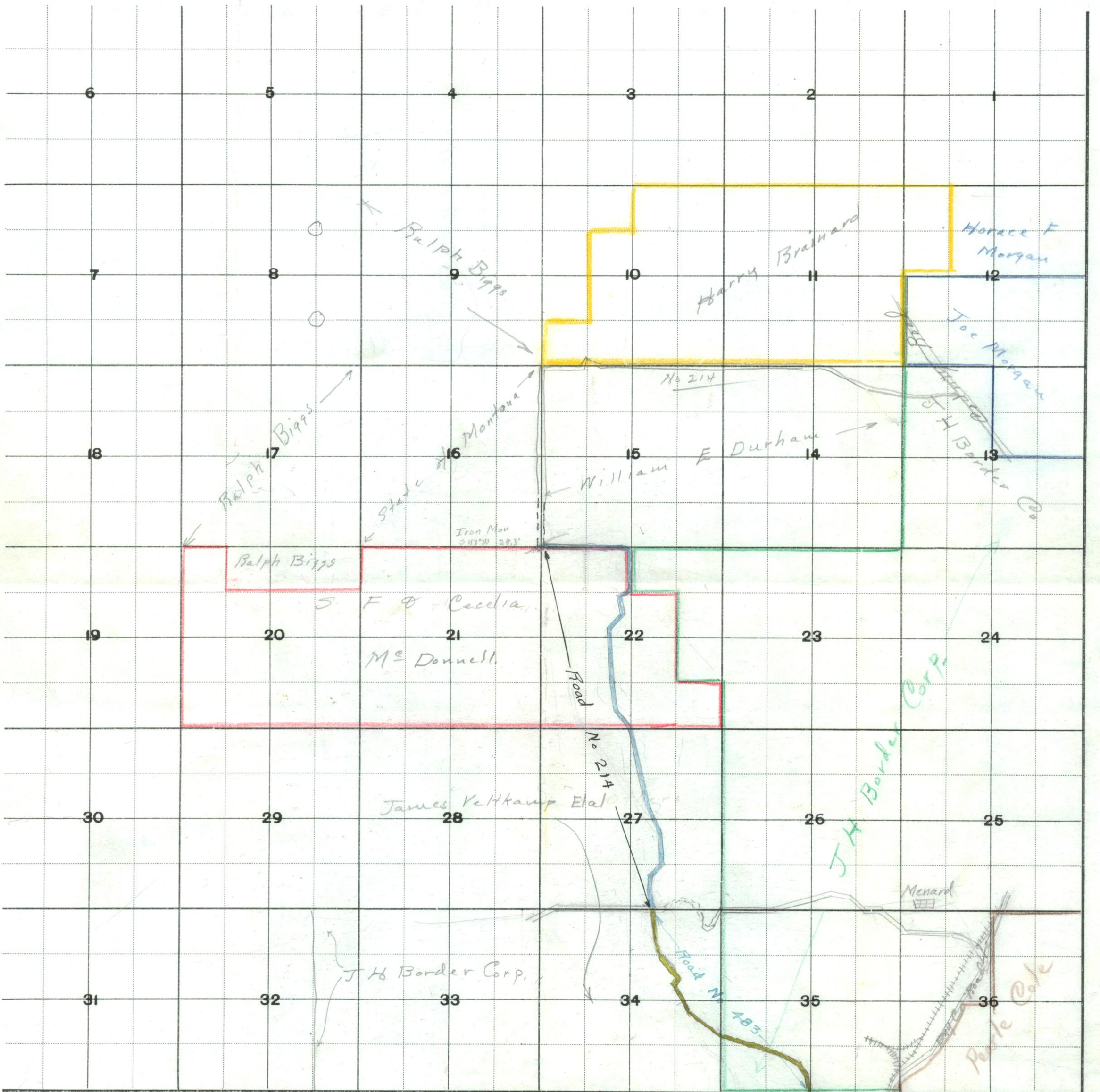

64-A TOWNSHIP PLAT, PRINTED QM - T-YZ

STATE PUBLISHING CO., HELENA, MONT.

SCALE: 40 CHAINS TO AN INCH

T 2 N. R 4 E



Form 3806-S (Rev. 2-52)

Receipt for Registered Article No. 2099

Fee paid 30 cents. Class postage

Declared value Surchage paid, \$

Return Receipt fee Spl. Del'y fee Delivery restricted to addressee:

In person, or order Accepting employee will place his initials in space indicating restricted delivery.

NOTICE TO SENDER—Enter below name and address of addressee as an identification. Preserve and submit this receipt in case of inquiry or application for indemnity.

S. F. McDonnell Manhattan, Mont. (Name of addressee) (P. O. and State of address)

Postmaster per



Form 3806-S (Rev. 2-52)

Receipt for Registered Article No. 2105

Fee paid 30 cents. Class postage

Declared value Surchage paid, \$

Return Receipt fee Spl. Del'y fee Delivery restricted to addressee:

In person, or order Accepting employee will place his initials in space indicating restricted delivery.

NOTICE TO SENDER—Enter below name and address of addressee as an identification. Preserve and submit this receipt in case of inquiry or application for indemnity.

C. E. Brainard Maudlow, Mont. (Name of addressee) (P. O. and State of address)

Postmaster per

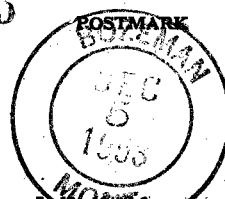

Form 3806-S (Rev. 2-52)

Receipt for Registered Article No. 2100

Fee paid 30 cents. Class postage

Declared value Surchage paid, \$

Return Receipt fee Spl. Del'y fee Delivery restricted to addressee:

In person, or order Accepting employee will place his initials in space indicating restricted delivery.

NOTICE TO SENDER—Enter below name and address of addressee as an identification. Preserve and submit this receipt in case of inquiry or application for indemnity.

James Veltkamp Manhattan, Mont. (Name of addressee) (P. O. and State of address)

Postmaster per

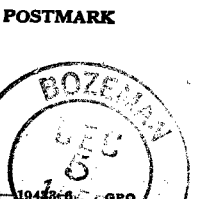

Form 3806-S (Rev. 2-52)

Receipt for Registered Article No. 2106

Fee paid 30 cents. Class postage

Declared value Surchage paid, \$

Return Receipt fee Spl. Del'y fee Delivery restricted to addressee:

In person, or order Accepting employee will place his initials in space indicating restricted delivery.

NOTICE TO SENDER—Enter below name and address of addressee as an identification. Preserve and submit this receipt in case of inquiry or application for indemnity.

Walter Brainard Maudlow (Name of addressee) (P. O. and State of address)

Postmaster per



Form 3806-S (Rev. 2-52)

Receipt for Registered Article No. 2101

Fee paid 30 cents. Class postage

Declared value Surchage paid, \$

Return Receipt fee Spl. Del'y fee Delivery restricted to addressee:

In person, or order Accepting employee will place his initials in space indicating restricted delivery.

NOTICE TO SENDER—Enter below name and address of addressee as an identification. Preserve and submit this receipt in case of inquiry or application for indemnity.

Mrs. Evelyn Veltkamp Manhattan, Mont. (Name of addressee) (P. O. and State of address)

Postmaster per

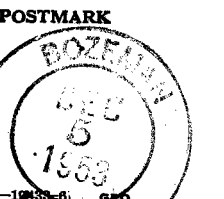

Form 3806-S (Rev. 2-52)

Receipt for Registered Article No. 2107

Fee paid 30 cents. Class postage

Declared value Surchage paid, \$

Return Receipt fee Spl. Del'y fee Delivery restricted to addressee:

In person, or order Accepting employee will place his initials in space indicating restricted delivery.

NOTICE TO SENDER—Enter below name and address of addressee as an identification. Preserve and submit this receipt in case of inquiry or application for indemnity.

Walter R. Brainard Maudlow, Mont. (Name of addressee) (P. O. and State of address)

Postmaster per

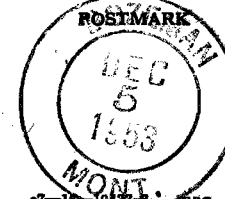

Form 3806-S (Rev. 2-52)

Receipt for Registered Article No. 2102

Fee paid 30 cents. Class postage

Declared value Surchage paid, \$

Return Receipt fee Spl. Del'y fee Delivery restricted to addressee:

In person, or order Accepting employee will place his initials in space indicating restricted delivery.

NOTICE TO SENDER—Enter below name and address of addressee as an identification. Preserve and submit this receipt in case of inquiry or application for indemnity.

Harry Brainard, Maudlow, Mont. (Name of addressee) (P. O. and State of address)

Postmaster per

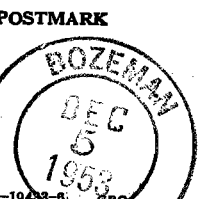

Form 3806-S (Rev. 2-52)

Receipt for Registered Article No. 2108

Fee paid 30 cents. Class postage

Declared value Surchage paid, \$

Return Receipt fee Spl. Del'y fee Delivery restricted to addressee:

In person, or order Accepting employee will place his initials in space indicating restricted delivery.

NOTICE TO SENDER—Enter below name and address of addressee as an identification. Preserve and submit this receipt in case of inquiry or application for indemnity.

Roy Callantine Maudlow, Mont. (Name of addressee) (P. O. and State of address)

Postmaster per



Form 3806-S (Rev. 2-52)

Receipt for Registered Article No. 2103

Fee paid 30 cents. Class postage

Declared value Surchage paid, \$

Return Receipt fee Spl. Del'y fee Delivery restricted to addressee:

In person, or order Accepting employee will place his initials in space indicating restricted delivery.

NOTICE TO SENDER—Enter below name and address of addressee as an identification. Preserve and submit this receipt in case of inquiry or application for indemnity.

Thomas Veltkamp Manhattan, Mont. (Name of addressee) (P. O. and State of address)

Postmaster per

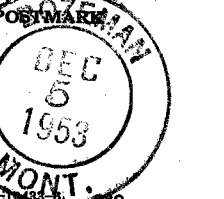

Form 3806-S (Rev. 2-52)

Receipt for Registered Article No. 2109

Fee paid 30 cents. Class postage

Declared value Surchage paid, \$

Return Receipt fee Spl. Del'y fee Delivery restricted to addressee:

In person, or order Accepting employee will place his initials in space indicating restricted delivery.

NOTICE TO SENDER—Enter below name and address of addressee as an identification. Preserve and submit this receipt in case of inquiry or application for indemnity.

Richard Andrus Belgrade, Mont. (Name of addressee) (P. O. and State of address)

Postmaster per



Form 3806-S (Rev. 2-52)

Receipt for Registered Article No. 2104

Fee paid 30 cents. Class postage

Declared value Surchage paid, \$

Return Receipt fee Spl. Del'y fee Delivery restricted to addressee:

In person, or order Accepting employee will place his initials in space indicating restricted delivery.

NOTICE TO SENDER—Enter below name and address of addressee as an identification. Preserve and submit this receipt in case of inquiry or application for indemnity.

Maynard Sinton Manhattan, Mont. (Name of addressee) (P. O. and State of address)

Postmaster per

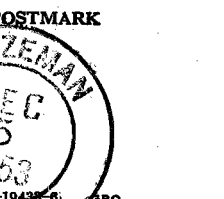





### RETURN RECEIPT

Received from the Postmaster the Registered or Insured Article, the number of which appears on the face of this Card.

1 Harry Braun  
(Signature or name of addressee)

2 \_\_\_\_\_  
(Signature of addressee's agent—Agent should enter addressee's name on line ONE above)

Date of delivery Dec 30, 1953

### RETURN RECEIPT

Received from the Postmaster the Registered or Insured Article, the number of which appears on the face of this Card.

1 William D. Brainerd  
(Signature or name of addressee)

2 by Mrs. C. E. Brainerd  
(Signature of addressee's agent—Agent should enter addressee's name on line ONE above)

Date of delivery Dec 15, 1953

### RETURN RECEIPT

Received from the Postmaster the Registered or Insured Article, the number of which appears on the face of this Card.

1 C. E. Brainerd  
(Signature or name of addressee)

2 by Mrs. C. E. Brainerd  
(Signature of addressee's agent—Agent should enter addressee's name on line ONE above)

Date of delivery Dec 15, 1953

### RETURN RECEIPT

Received from the Postmaster the Registered or Insured Article, the number of which appears on the face of this Card.

1 \_\_\_\_\_  
(Signature or name of addressee)

2 Mrs. Lillian Brainerd  
(Signature of addressee's agent—Agent should enter addressee's name on line ONE above)

Date of delivery \_\_\_\_\_, 19\_\_\_\_

### RETURN RECEIPT

Received from the Postmaster the Registered or Insured Article, the number of which appears on the face of this Card.

1 Richard E. Brainerd  
(Signature or name of addressee)

2 May E. Brainerd  
(Signature of addressee's agent—Agent should enter addressee's name on line ONE above)

Date of delivery Dec 7, 1953

### RETURN RECEIPT

Received from the Postmaster the Registered or Insured Article, the number of which appears on the face of this Card.

1 Mrs. Brainerd  
(Signature or name of addressee)

2 \_\_\_\_\_  
(Signature of addressee's agent—Agent should enter addressee's name on line ONE above)

Date of delivery Dec 7, 19\_\_\_\_



### RETURN RECEIPT

Received from the Postmaster the Registered or Insured Article, the number of which appears on the face of this Card.

1 J. H. Barber  
(Signature or name of addressee)

2 Echel H Barber  
(Signature of addressee's agent—Agent should enter addressee's name on line ONE above)

Date of delivery Dec 7, 1953

### RETURN RECEIPT

Received from the Postmaster the Registered or Insured Article, the number of which appears on the face of this Card.

1 Joe Morgan  
Harold Miller  
(Signature or name of addressee)

2 \_\_\_\_\_  
(Signature of addressee's agent—Agent should enter addressee's name on line ONE above)

Date of delivery Dec 7, 1953

### RETURN RECEIPT

Received from the Postmaster the Registered or Insured Article, the number of which appears on the face of this Card.

1 G W Hamble  
(Signature or name of addressee)

2 \_\_\_\_\_  
(Signature of addressee's agent—Agent should enter addressee's name on line ONE above)

Date of delivery Dec 8, 1953

### RETURN RECEIPT

Received from the Postmaster the Registered or Insured Article, the number of which appears on the face of this Card.

1 Wesley Brunell  
(Signature or name of addressee)

2 Bob Brunell  
(Signature of addressee's agent—Agent should enter addressee's name on line ONE above)

Date of delivery Dec 7, 1953

### RETURN RECEIPT

Received from the Postmaster the Registered or Insured Article, the number of which appears on the face of this Card.

1 \_\_\_\_\_  
(Signature or name of addressee)

2 \_\_\_\_\_  
(Signature of addressee's agent—Agent should enter addressee's name on line ONE above)

Date of delivery 12-12, 1953

### RETURN RECEIPT

Received from the Postmaster the Registered or Insured Article, the number of which appears on the face of this Card.

1 \_\_\_\_\_  
(Signature or name of addressee)

2 \_\_\_\_\_  
(Signature of addressee's agent—Agent should enter addressee's name on line ONE above)

Date of delivery \_\_\_\_\_, 19\_\_\_\_

### RETURN RECEIPT

Received from the Postmaster the Registered or Insured Article, the number of which appears on the face of this Card.

1 *[Signature]*  
(Signature or name of addressee)

2 *[Signature]*  
(Signature of addressee's agent—Agent should enter addressee's name on line ONE above)

Date of delivery *Dec 7*, 19*53*

### RETURN RECEIPT

Received from the Postmaster the Registered or Insured Article, the number of which appears on the face of this Card.

1 *[Signature]*  
(Signature or name of addressee)

2 *[Signature]*  
(Signature of addressee's agent—Agent should enter addressee's name on line ONE above)

Date of delivery *12/8*, 19*53*

### RETURN RECEIPT

Received from the Postmaster the Registered or Insured Article, the number of which appears on the face of this Card.

1 *William E. [Signature]*  
(Signature or name of addressee)

2 *[Signature]*  
(Signature of addressee's agent—Agent should enter addressee's name on line ONE above)

Date of delivery *Dec 8*, 19*53*

### RETURN RECEIPT

Received from the Postmaster the Registered or Insured Article, the number of which appears on the face of this Card.

1 *Mrs. C. L. Veltkamp*  
(Signature or name of addressee)

2 *[Signature]*  
(Signature of addressee's agent—Agent should enter addressee's name on line ONE above)

Date of delivery *DEC 8 1953*, 19

### RETURN RECEIPT

Received from the Postmaster the Registered or Insured Article, the number of which appears on the face of this Card.

1 *Mrs. Cecelia M. [Signature]*  
(Signature or name of addressee)

2 *[Signature]*  
(Signature of addressee's agent—Agent should enter addressee's name on line ONE above)

Date of delivery *12/7*, 19*53*

### RETURN RECEIPT

Received from the Postmaster the Registered or Insured Article, the number of which appears on the face of this Card.

1 *S. F. M. [Signature]*  
(Signature or name of addressee)

2 *Mrs. S. F. M. [Signature]*  
(Signature of addressee's agent—Agent should enter addressee's name on line ONE above)

Date of delivery *12/7*, 19*53*

### RETURN RECEIPT

Received from the Postmaster the Registered or Insured Article, the number of which appears on the face of this Card.

1 *James Velikamp*  
(Signature or name of addressee)

2 \_\_\_\_\_  
(Signature of addressee's agent—Agent should enter addressee's name on line ONE above)

Date of delivery DEC 8 1953, 19\_\_

### RETURN RECEIPT

Received from the Postmaster the Registered or Insured Article, the number of which appears on the face of this Card.

1 *Miss Evelyn Veltkamp*  
(Signature or name of addressee)

2 \_\_\_\_\_  
(Signature of addressee's agent—Agent should enter addressee's name on line ONE above)

Date of delivery 12/7, 1953

### RETURN RECEIPT

Received from the Postmaster the Registered or Insured Article, the number of which appears on the face of this Card.

1 *Harry Braunard*  
(Signature or name of addressee)

2 \_\_\_\_\_  
(Signature of addressee's agent—Agent should enter addressee's name on line ONE above)

Date of delivery 12/7, 1953

### RETURN RECEIPT

Received from the Postmaster the Registered or Insured Article, the number of which appears on the face of this Card.

1 *Miss Evelyn Veltkamp*  
(Signature or name of addressee)

2 *Miss Evelyn Veltkamp*  
(Signature of addressee's agent—Agent should enter addressee's name on line ONE above)

Date of delivery 12/7, 1953

### RETURN RECEIPT

Received from the Postmaster the Registered or Insured Article, the number of which appears on the face of this Card.

1 *Maynard Ginton*  
(Signature or name of addressee)

2 \_\_\_\_\_  
(Signature of addressee's agent—Agent should enter addressee's name on line ONE above)

Date of delivery DEC 7 1953, 19\_\_

### RETURN RECEIPT

Received from the Postmaster the Registered or Insured Article, the number of which appears on the face of this Card.

1 *C. E. Braunard*  
(Signature or name of addressee)

2 *by Mrs. C. E. Braunard*  
(Signature of addressee's agent—Agent should enter addressee's name on line ONE above)

Date of delivery Dec 7, 1953

### RETURN RECEIPT

Received from the Postmaster the Registered or Insured Article, the number of which appears on the face of this Card.

1 Walter Brounend  
(Signature or name of addressee)

2 \_\_\_\_\_  
(Signature of addressee's agent—Agent should enter addressee's name on line ONE above)

Date of delivery Dec 9, 1953

### RETURN RECEIPT

Received from the Postmaster the Registered or Insured Article, the number of which appears on the face of this Card.

1 Walter R Brounend  
(Signature or name of addressee)

2 \_\_\_\_\_  
(Signature of addressee's agent—Agent should enter addressee's name on line ONE above)

Date of delivery Dec 7, 1953

### RETURN RECEIPT

Received from the Postmaster the Registered or Insured Article, the number of which appears on the face of this Card.

1 Roy C. Blanton  
(Signature or name of addressee)

2 \_\_\_\_\_  
(Signature of addressee's agent—Agent should enter addressee's name on line ONE above)

Date of delivery Dec 10, 1953

### RETURN RECEIPT

Received from the Postmaster the Registered or Insured Article, the number of which appears on the face of this Card.

1 Wesley Brounell  
(Signature or name of addressee)

2 \_\_\_\_\_  
(Signature of addressee's agent—Agent should enter addressee's name on line ONE above)

Date of delivery Dec 17, 1953

### RETURN RECEIPT

Received from the Postmaster the Registered or Insured Article, the number of which appears on the face of this Card.

1 J. M. Morgan  
(Signature or name of addressee)

2 Mrs. J. J. Morgan  
(Signature of addressee's agent—Agent should enter addressee's name on line ONE above)

Date of delivery Dec 17, 1953

### RETURN RECEIPT

Received from the Postmaster the Registered or Insured Article, the number of which appears on the face of this Card.

1 R. W. Blanton  
(Signature or name of addressee)

2 \_\_\_\_\_  
(Signature of addressee's agent—Agent should enter addressee's name on line ONE above)

Date of delivery Dec 17, 1953

### RETURN RECEIPT

Received from the Postmaster the Registered or Insured Article, the number of which appears on the face of this Card.

1 J. H. Barber  
(Signature or name of addressee)

2 E. H. Barber  
(Signature of addressee's agent—Agent should enter addressee's name on line ONE above)

Date of delivery Dec 17, 1953

### RETURN RECEIPT

Received from the Postmaster the Registered or Insured Article, the number of which appears on the face of this Card.

1 Steve Miller  
(Signature or name of addressee)

2 \_\_\_\_\_  
(Signature of addressee's agent—Agent should enter addressee's name on line ONE above)

Date of delivery Dec 17, 1953

### RETURN RECEIPT

Received from the Postmaster the Registered or Insured Article, the number of which appears on the face of this Card.

1 Frances M. Mendenhall  
(Signature or name of addressee)

2 Mr. J. J. Mendenhall  
(Signature of addressee's agent—Agent should enter addressee's name on line ONE above)

Date of delivery Dec 17, 1953

### RETURN RECEIPT

Received from the Postmaster the Registered or Insured Article, the number of which appears on the face of this Card.

1 William E. Durham  
(Signature or name of addressee)

2 Mr. William E. Durham  
(Signature of addressee's agent—Agent should enter addressee's name on line ONE above)

Date of delivery \_\_\_\_\_, 19\_\_\_\_

### RETURN RECEIPT

Received from the Postmaster the Registered or Insured Article, the number of which appears on the face of this Card.

1 Mrs. Otta M. Collins  
(Signature or name of addressee)

2 Mrs. Bill F. Collins  
(Signature of addressee's agent—Agent should enter addressee's name on line ONE above)

Date of delivery Dec 17, 1953

### RETURN RECEIPT

Received from the Postmaster the Registered or Insured Article, the number of which appears on the face of this Card.

1 Richard E. Andrus  
(Signature or name of addressee)

2 May E. Andrus  
(Signature of addressee's agent—Agent should enter addressee's name on line ONE above)

Date of delivery \_\_\_\_\_, 19\_\_\_\_

### RETURN RECEIPT

Received from the Postmaster the Registered or Insured Article, the number of which appears on the face of this Card.

1 M. M. Benson  
(Signature or name of addressee)

2 By Mrs. M. M. Benson  
(Signature of addressee's agent—Agent should enter addressee's name on line ONE above)

Date of delivery Dec. 17<sup>th</sup>, 1953

### RETURN RECEIPT

Received from the Postmaster the Registered or Insured Article, the number of which appears on the face of this Card.

1 Ralph Biggs  
(Signature or name of addressee)

2 \_\_\_\_\_  
(Signature of addressee's agent—Agent should enter addressee's name on line ONE above)

Date of delivery Dec 17, 1953

### RETURN RECEIPT

Received from the Postmaster the Registered or Insured Article, the number of which appears on the face of this Card.

1 Mr S. F. McDonnell  
(Signature or name of addressee)

2 Mr S. F. McDonnell  
(Signature of addressee's agent—Agent should enter addressee's name on line ONE above)

Date of delivery DEC 17 1953, 1953

### RETURN RECEIPT

Received from the Postmaster the Registered or Insured Article, the number of which appears on the face of this Card.

1 Mary Ann Ryan  
(Signature or name of addressee)

2 Edward Ryan  
(Signature of addressee's agent—Agent should enter addressee's name on line ONE above)

Date of delivery \_\_\_\_\_, 19\_\_\_\_

Form 3811  
Rev. 1-52

### RETURN RECEIPT

Received from the Postmaster the Registered or Insured Article, the number of which appears on the face of this Card.

1 \_\_\_\_\_  
(Signature or name of addressee)

2 \_\_\_\_\_  
(Signature of addressee's agent—Agent should enter addressee's name on line ONE above)

Date of delivery 12/18, 19\_\_\_\_

U. S. GOVERNMENT PRINTING OFFICE 16-12431-2

Form 3811  
Rev. 1-52

### RETURN RECEIPT

Received from the Postmaster the Registered or Insured Article, the number of which appears on the face of this Card.

1 \_\_\_\_\_  
(Signature or name of addressee)

2 \_\_\_\_\_  
(Signature of addressee's agent—Agent should enter addressee's name on line ONE above)

Date of delivery 12-29, 1953

U. S. GOVERNMENT PRINTING OFFICE 16-12431-2

### RETURN RECEIPT

Received from the Postmaster the Registered or Insured Article, the number of which appears on the face of this Card.

1 Mrs. Helen V. [unclear]  
(Signature or name of addressee)

2 \_\_\_\_\_  
(Signature of addressee's agent—Agent should enter addressee's name on line ONE above)

Date of delivery 12-29, 1950

### RETURN RECEIPT

Received from the Postmaster the Registered or Insured Article, the number of which appears on the face of this Card.

1 Mrs. Cecelia M. McDonnell  
(Signature or name of addressee)

2 \_\_\_\_\_  
(Signature of addressee's agent—Agent should enter addressee's name on line ONE above)

Date of delivery \_\_\_\_\_, 1953

### RETURN RECEIPT

Received from the Postmaster the Registered or Insured Article, the number of which appears on the face of this Card.

1 Thomas Waltham  
(Signature or name of addressee)

2 By Mrs. Thomas Waltham  
(Signature of addressee's agent—Agent should enter addressee's name on line ONE above)

Date of delivery 12/18, 1953

### RETURN RECEIPT

Received from the Postmaster the Registered or Insured Article, the number of which appears on the face of this Card.

1 Ray Callan  
(Signature or name of addressee)

2 \_\_\_\_\_  
(Signature of addressee's agent—Agent should enter addressee's name on line ONE above)

Date of delivery Dec 21, 1953