

No. 600

PETITIONER:

G.A. Breibach, W.L. Inabnit, et al.

Petition filed Apr. 10, 1951

For Closing Road No. 62

Viewers appointed N. & E. of Sedan 191

Report filed 191

Date of hearing May 14, 1951

Report approved 191

Order of survey 191

Surveyed 191

Field Book No. Page

Recorded in Roadbook 191

Declared County Road 191

Petition denied May 14, 1951

Approved: Chairman

See Book 29 Commissioners' Proceedings,

pages 37-71

County Clerk

PETITION FOR ABANDONING A PUBLIC HIGHWAY

600

To the Honorable Board of
County Commissioners of
Gallatin County, Montana

Gentlemen:

We, the undersigned freeholders of Gallatin County,
do hereby petition your Honorable Body to abandon as a public
highway the following described County Road:

That portion of County Road No. 62, beginning
at the Southwest corner of Section 25, in Township
3 North of Range 7 East, M.P.M., thence running
East along said County Road One (1) mile to the
Southeast corner of said Section 25, a distance
of one mile.

NAMES OF PETITIONERS

	<u>W.L. Jesabert</u> ✓
<i>Wilson</i>	<u>G.A. Britsch</u> ✓
<i>Wilson</i>	<u>Mark Cowan</u> ✓
<i>Wilson</i>	<u>A.L. Shelburne</u> ✓
<i>Wilson</i>	<u>Mrs. Mark Cowan</u> ✓
<i>Wilson</i>	<u>Mrs. A.L. Shelburne</u> ✓
<i>Wilson</i>	<u>Lyle R. Richman</u> ✓
<i>Wilson</i>	<u>Russ Koch</u> ✓
<i>Wilson</i>	<u>Wendell Francis</u> ✓
	<u>O.C. Koch</u> ✓
	<u>P.A. Kanegard</u> ✓

*all signed
on 5/14/21*

12

Hearing set for May 14th - 21

NOTICE OF HEARING UPON PETITION NO. 600 FOR THE CLOSING OF COUNTY ROAD NO. 62, BETWEEN THE POINTS DESCRIBED IN THE PETITION FILED HEREIN.

YOU ARE HEREBY NOTIFIED That a meeting of the Board of County Commissioners of Gallatin County, Montana, will be held in the office of the said County Commissioners at the Courthouse in the City of Bozeman, County of Gallatin, State of Montana, on the 14th day of May, A. D. 1951, at Two (2) o'clock p. m. of said day, to consider the Petition filed for the closing of County Road No. 62, described as follows:

That portion of County Road No. 62, beginning at the Southwest corner of Section 25, in Township 3 North of Range 7 East, M. P. M., thence running East along said County Road One (1) Mile to the Southeast corner of said Section 25, a distance of one mile.

You are further notified that if you have any objections to the closing of said Road, as petitioned, you may appear at the time and place as above given and present your objections to the Board of County Commissioners of Gallatin County, State of Montana, at that time and place.

Dated at Bozeman, Montana, this 2nd day of May, A. D. 1951.

BOARD OF COUNTY COMMISSIONERS OF
GALLATIN COUNTY, STATE OF MONTANA

By _____

Chairman

The undersigned freeholders oppose the closing of the road known as
 the Bohart road starting at the South West of section 25 and
 North West corner of section 36 and continuing ~~in~~^x
~~ea~~^{ea} ~~to~~^{to} the North East corner of section of 36 and south
 east corner of section 25 Twp 3North Range 7 East. xxxxxxxxxxxx

Signed

~~Ross Kime~~
 Grace Blattie
 Lawrence Blattie
 Walter C. Thompson
 Geo Peterson
 Alfred Wilson
 Henry Woodley
 Louisa Peterson
 W L Snabert +
 Wendell Francis
 A. A. Pergande
 Anita Francis
 Lyle R. Reichman
 Mrs Lyle Reichman
 Ethel L. Wilson
 R. D. Lantz
 M. D. Lantz

Mrs. R. D. Jones
 Wesley Palmer
 Dorothy Palmer
 Hilbur H. Reinke
 Mrs. W. H. Reinke
 Mike Riggs
 Roy Weddell
 Joyce Haddell +
 J. L. Burns.
 A. W. Lantz
 Roberta Fastje
 Art Fastje
 Conant a Chriske +
 Helen M. Chriske
 Barney Fastje
 Henry Fastje
 Hank Cowan +

May 14, 1951

Mr. Wendell Francis
Wilsall, Montana

Dear Mr. Francis:

In regard to closing Road No. 62, in Section 25,
T. 3 N., R. 7 E., after the hearing of the objectors
it was unanimously decided that the road be left open.

Very truly yours,

BOARD OF COUNTY COMMISSIONERS

By _____

Chairman

JOEN-d

Petition 600

From the Desk of
J. O. E. Nelson

Item from Commissioners' minutes
of May 14, 1951:

Motion was made
..... closing of road No. 62,
as described in Petition No. 600,
be denied.

T 3 N
R 7 E

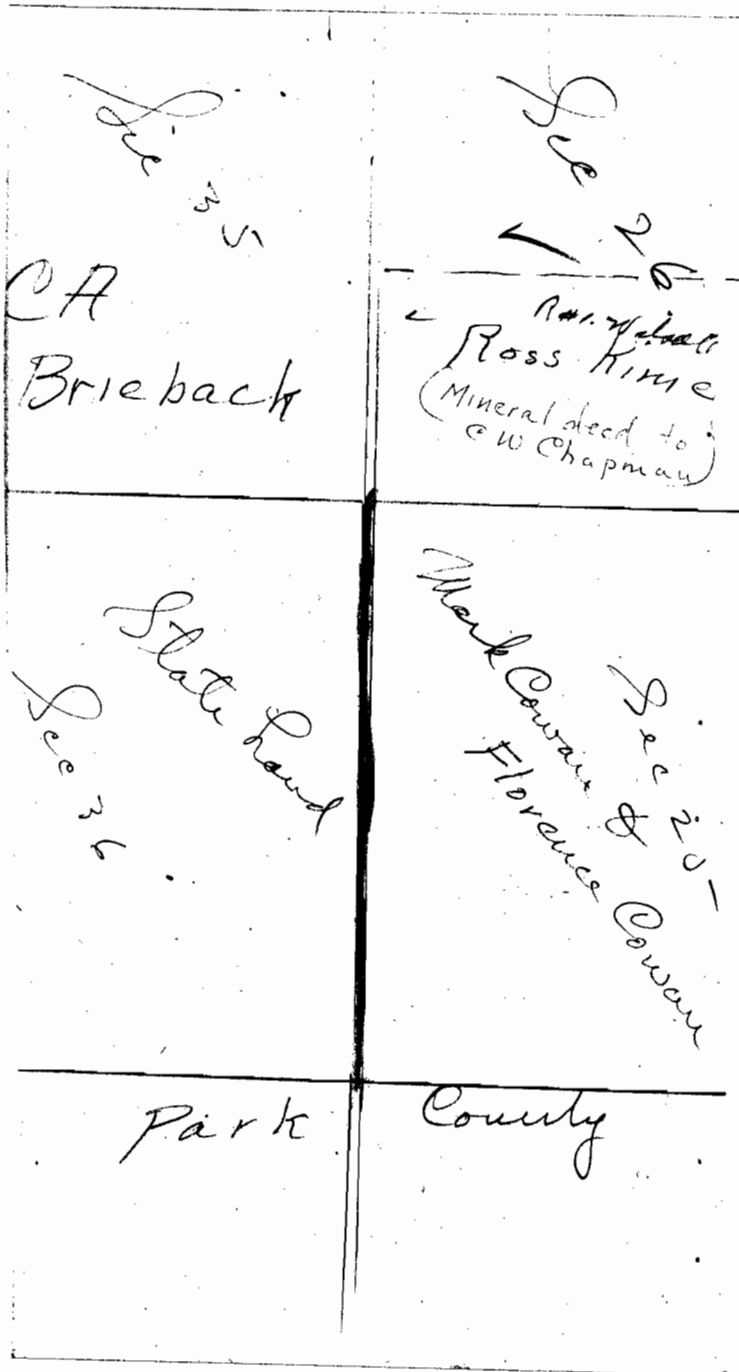

RETURN RECEIPT

Received from the Postmaster the Registered or Insured Article, the original number of which appears on the face of this Card.

1 Wendell Francis
(Signature or name of addressee)

2 _____
(Signature of addressee's agent—Agent should enter addressee's name on line ONE above)

Date of delivery MAY 4 1951, 19____

RETURN RECEIPT

Received from the Postmaster the Registered or Insured Article, the original number of which appears on the face of this Card.

1 Mrs Mark Cowan
(Signature or name of addressee)

2 _____
(Signature of addressee's agent—Agent should enter addressee's name on line ONE above)

Date of delivery MAY 4 1951, 19____

RETURN RECEIPT

Received from the Postmaster the Registered or Insured Article, the original number of which appears on the face of this Card.

1 Kirk Koel
(Signature or name of addressee)

2 _____
(Signature of addressee's agent—Agent should enter addressee's name on line ONE above)

Date of delivery MAY 4 1951, 19____

RETURN RECEIPT

Received from the Postmaster the Registered or Insured Article, the original number of which appears on the face of this Card.

1 W. L. Inabnit
(Signature or name of addressee)

2 _____
(Signature of addressee's agent—Agent should enter addressee's name on line ONE above)

Date of delivery MAY 4 1951, 19____

RETURN RECEIPT

Received from the Postmaster the Registered or Insured Article, the original number of which appears on the face of this Card.

1 Mark Cowan
(Signature or name of addressee)

2 _____
(Signature of addressee's agent—Agent should enter addressee's name on line ONE above)

Date of delivery MAY 4 1951, 19____

RETURN RECEIPT

Received from the Postmaster the Registered or Insured Article, the original number of which appears on the face of this Card.

1 M. P. E. Koel
(Signature or name of addressee)

2 _____
(Signature of addressee's agent—Agent should enter addressee's name on line ONE above)

Date of delivery MAY 4 1951, 19____

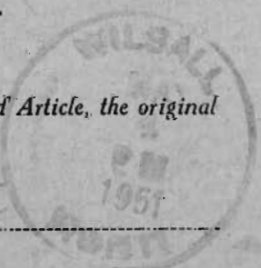

RETURN RECEIPT

Received from the Postmaster the Registered or Insured Article, the original number of which appears on the face of this Card.

1 Lyle Richman
(Signature or name of addressee)

2 Mrs. Lyle Richman
(Signature of addressee's agent—Agent should enter addressee's name on line ONE above)

Date of delivery MAY 1 1951, 1951

RETURN RECEIPT

Received from the Postmaster the Registered or Insured Article, the original number of which appears on the face of this Card.

1 Mr. A. C. Shelhamer
(Signature or name of addressee)

2 Mrs. A. C. Shelhamer
(Signature of addressee's agent—Agent should enter addressee's name on line ONE above)

Date of delivery MAY 5 - 1951, 1951

RETURN RECEIPT

Received from the Postmaster the Registered or Insured Article, the original number of which appears on the face of this Card.

1 Mr. A. C. Shelhamer
(Signature or name of addressee)

2 _____
(Signature of addressee's agent—Agent should enter addressee's name on line ONE above)

Date of delivery MAY 5 - 1951, 1951

RETURN RECEIPT

Received from the Postmaster the Registered or Insured Article, the original number of which appears on the face of this Card.

1 Ross Time
(Signature or name of addressee)

2 _____
(Signature of addressee's agent—Agent should enter addressee's name on line ONE above)

Date of delivery MAY 4 1951, 1951

RETURN RECEIPT

Received from the Postmaster the Registered or Insured Article, the original number of which appears on the face of this Card.

1 H. G. Richman
(Signature or name of addressee)

2 _____
(Signature of addressee's agent—Agent should enter addressee's name on line ONE above)

Date of delivery MAY 4 1951, 1951

Form 3811
Rev. 1-4-40

U. S. GOVERNMENT PRINTING OFFICE 16-12421

RETURN RECEIPT

Received from the Postmaster the Registered or Insured Article, the original number of which appears on the face of this Card.

1 Raymond A. Kamegard
(Signature or name of addressee)

2 AK.
(Signature of addressee's agent—Agent should enter addressee's name on line ONE above)

Date of delivery MAY 4 1951, 1951

Form 3811
Rev. 1-4-40

U. S. GOVERNMENT PRINTING OFFICE 16-12421