

No. 447

PETITIONER

S. F. Elliott.

Petition filed Dec 15, 1914

Viewers appointed 191

Report filed 191

Date of hearing 191

Report approved 191

Order of survey Aug 8 1916

Surveyor's Report filed 191

Declared County Road Aug 8 1916

See Book 11 Commissioners' Proceedings.

pages 440-595

Recorded, Road Book, pages

County Clerk

Chapter 72, Thirteenth Session 1913, Sections 1-2-18

CHAPTER IV

Section 1. Any ten, or a majority, of the free holders of a road district, taxable therein for road purposes, may petition in writing, the Board of County Commissioners to, establish, change or discontinue any common highway therein. When such a highway is petitioned for upon the dividing line between two counties, the same course must be pursued as in other cases, except that a copy of the petition must be presented

to the Board of County Commissioners of each County, who may appoint viewers to act jointly and the viewers so appointed must report their findings to both Boards.

Section 2. The petition must be set forth and describe particularly the highways to be abandoned, discontinued, altered or constructed, and if the same is to be altered, laid-out or constructed, the general route thereof, over what lands, who are owners thereof, whether

such of them as can be found consent thereto, and if not the probable cost of the right-of-way, where consent is not had, the necessity for, and advantage of the proposed road.

Section 18. Highways must be laid out and opened when practicable or upon subdivision or section lines, Provided, however, that the section shall not be construed to prevent oads being laid out on diagonal lines when public purposes shall be best subserved thereby.

Plat of Proposed Road

Township No. _____ Range No. _____

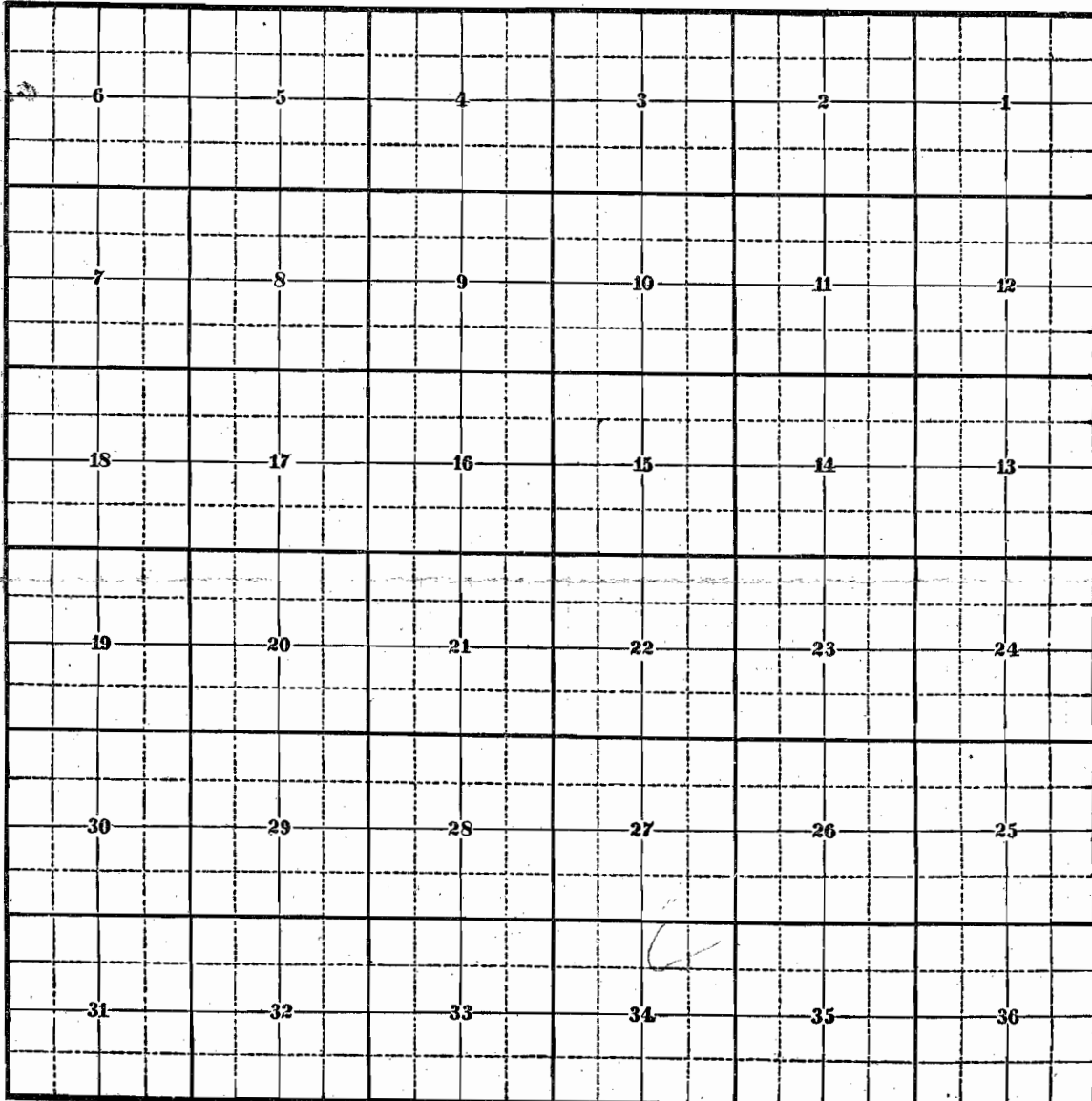

Scale 80 chains to an inch
20 40 60 80

From Meridian

No. 497

PETITION FOR ROAD

Principle Petitioner.....
S. F. Elliott

Filed this *15th* day of *Dec.*, 19*14*
S. A. Schumaker
County Clerk and Recorder

By Deputy

Viewers

Appointed 19.....

To meet..... 19.....

At

On

Report of Viewers

Filed

Action by the Board.....

Road Dist. No.

T2S R5E

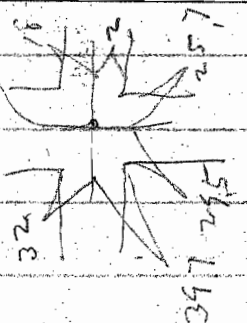
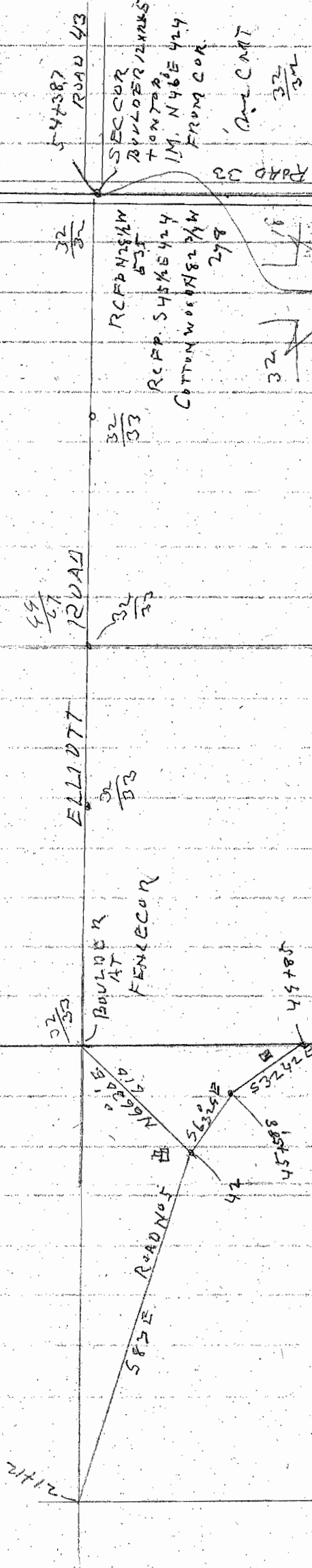

From SE Cor 20 3 miles E

26475

22
31
77

58
53
54+66
4278

38 ✓
1323 ✓
1328 ✓
Cul 12 x 48 x 24
to town of Juneau N
Cul 12 x 48 x 20

1408 ✓ Elliotts house 100 ft N

1626 ✓ Center of middle Co. Chan on L 31 to 13 ^{off same with} concrete about

2320 ✓ center of middle Co. Chan on L 15 W 16 ^{conc about 4 ft above}

2368 ✓ cul 4 x 1 x 16

2641 ✓ set stake on W 14

2648 ✓ June 5

2950 ✓ Concrete cul 8 x 12 x 18

3773 ✓ June N + S

8930
3952
12938
5038
1925
7003

14
125
56251
26251
30000
=6474

4040 ✓ Con Cul 8 x 12 x 18

1920
2029

4368 ✓ " " 20 x 14 x 18

4830 ✓ Elliotts house 100 ft N

4985 ✓ Con cul 10 x 16 x 18
to SW. Cor. Sec. 20

5295