

No. 386

PETITIONER

Bozeman Milling Co.

Petition filed June 12th 1912

Viewers appointed 191

Report filed 191

Date of hearing 191

Report approved 191

Order of survey 191

Surveyor's Report filed July 27 1912

Declared County Road July 2 1912

Petition

July 2nd
H. H. Spens 1912

See Book Commissioners' Proceedings,
pages

Recorded, Road Book, pages

..... County Clerk

Petition for Road

To The Hon. Board of County Commissioners, of Gallatin County, Mont.:

THE UNDERSIGNED, Your petitioners, Citizens of the United States, respectfully show and represent that they are residents and freeholders in Road District No. _____, in the County of Gallatin, State of Montana, and taxable therein for road purposes, when the road, hereinafter petitioned for, is to be located, laid out and established, if this petition be granted; that the proposed road is a public convenience, and, we think, the public good requires it.

Your petitioners do respectfully ask and petition that a County Road _____ ⁶⁰ feet in width, to be a public highway, to be laid out, located and established.

And show

- (a) The general route of the proposed road.
- (b) Over what lands it is proposed to be established.
- (c) Who are the owners thereof.
- (d) Whether such of them as can be found, consent thereto.
- (e) Who of them do not consent.
- (f) The probable cost of such right-of-way where such consent is not had.
- (g) The necessity for and advantages of the proposed road as follows, to-wit:

(a) General route of road as shown by Red lines on attached map.

(b) Over lands owned by Bozeman Milling Co.

(c) Bozeman Milling Company

(d) " " " " Consents

(e) None

(f) Nothing to County

(g) It has become necessary for the Bozeman Milling Company to build additional warehouses and due to the location of the N. Pac. Ry tracks, spur etc. especially the line of the Gallatin Valley Ry Co. and spurs, a warehouse can only be located to the North of the present warehouse, making it necessary to cover the present County road by an addition built adjoining the north side of present warehouse.

38d

No.

Road Petition

Petitioner *Bozeman Milling Co*
 Filed *June 12th 1912*

NAMES

- 1 *Bozeman Milling Company*
- 2 *J. O. Stone*
- 3 *C. F. Menzel*
- 4 *Rudolf W. W. R.*
- 5 *Mrs. W. C. ...*

NAMES

- 6 *B. ...*
- 7 *W. O. Bohart*
- 8 *J. M. ...*
- 9 *J. T. ...*
- 10 *George ...*

FILED
 JUN 13 - 1912 (6-13-12)
 County Clerk
 By _____ Deputy

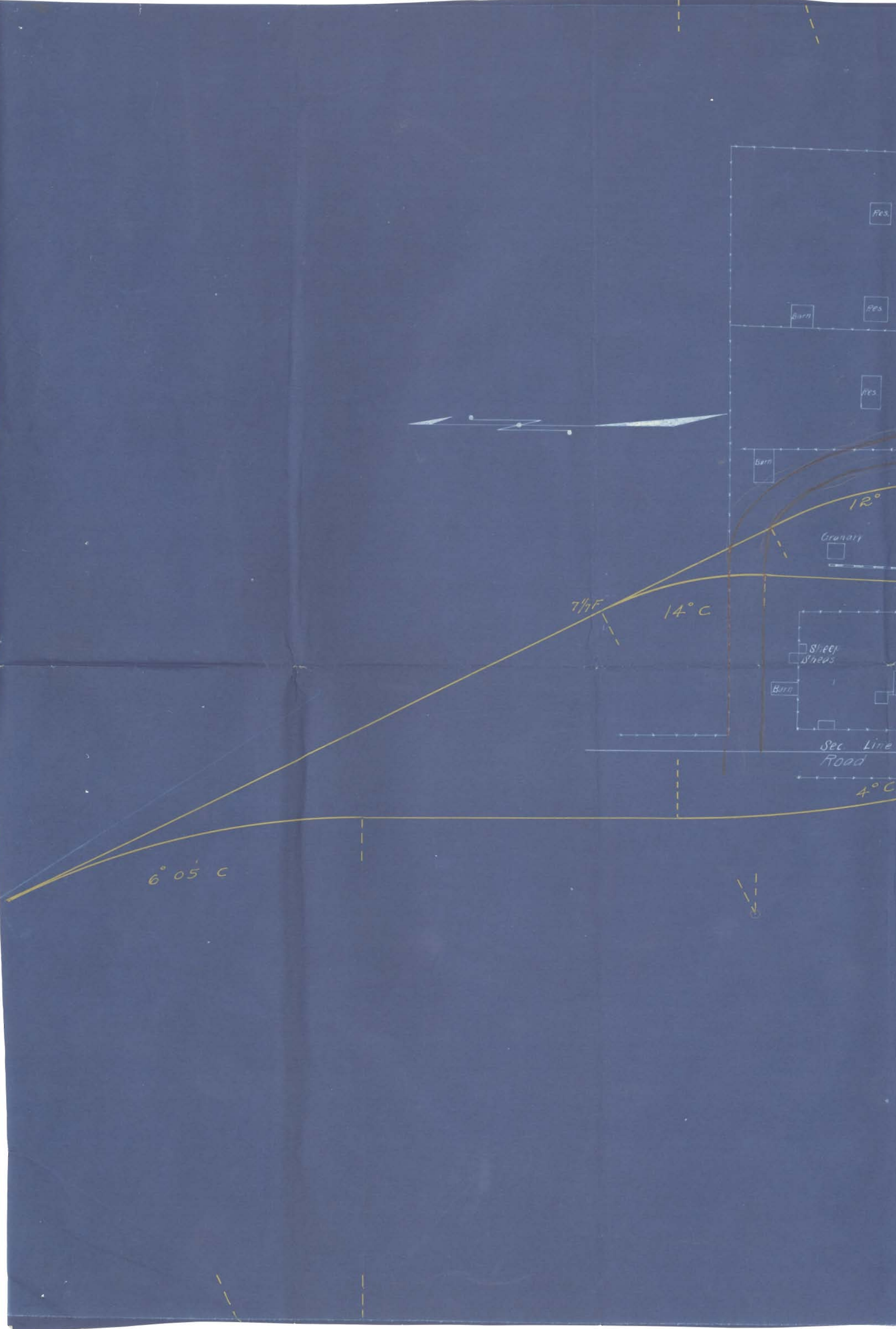

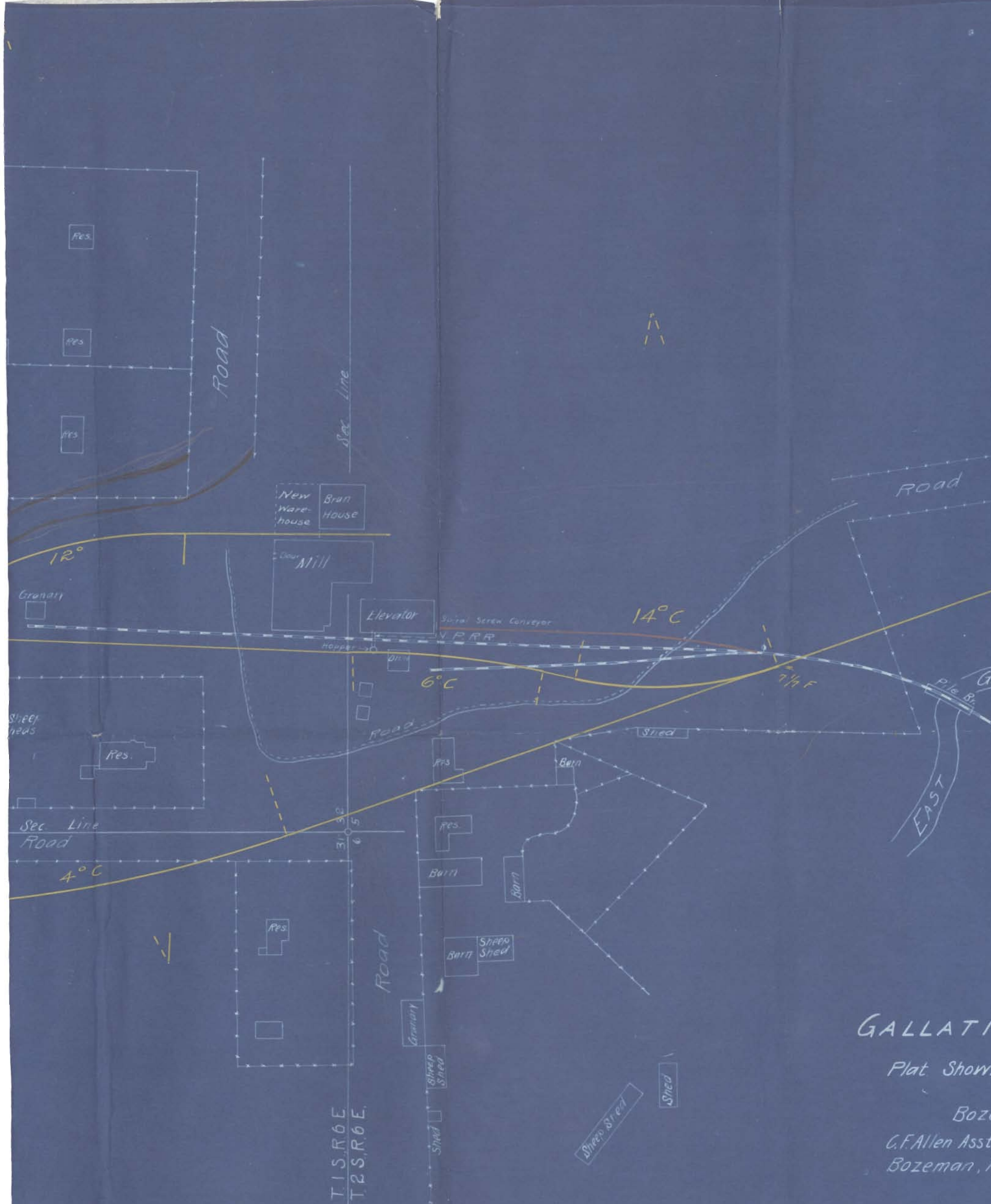

GALLATI

Plat Show

Boze

G.F. Allen Asst.

Bozeman, M

EN 112

— Proposed Gallatin Valley Ry. Tracks
 — Proposed Change of N. P. Ry. Switching Tracks

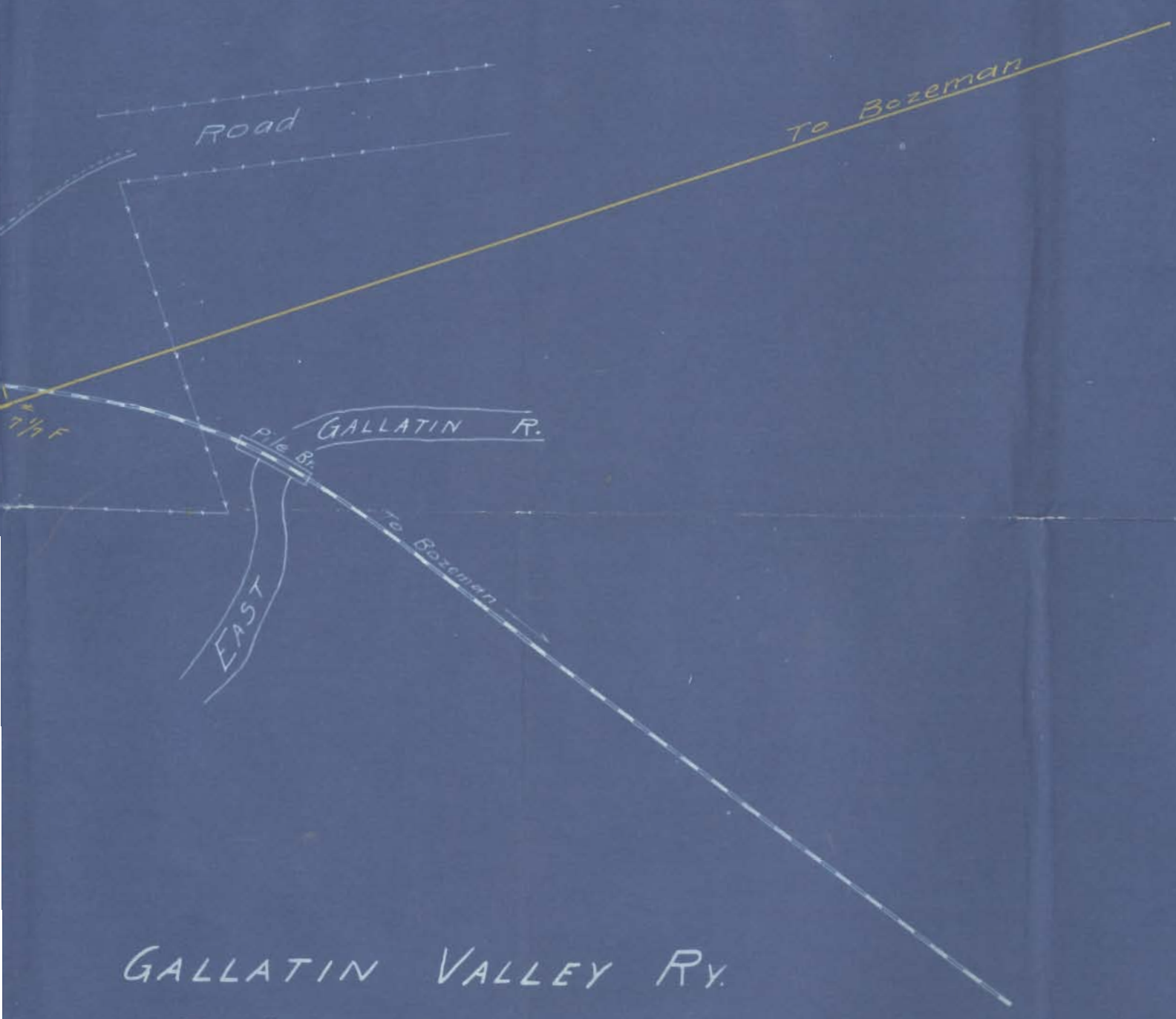

GALLATIN VALLEY RY.

Plat Showing Proposed Layout
 At
 Bozeman Mills

G. F. Allen Asst. Engr. Scale 1 inch = 100 feet
 Bozeman, Mont. April 17, 1912

EN 112