

Road No. 176

No. of Case _____

GALLATIN COUNTY,
DISTRICT COURT,
NINTH JUDICIAL DISTRICT,
STATE OF MONTANA.

J. D. Huffnie & H. H. Pitman et al
Plaintiff
vs.
C. M. Line et al
Defendant

Filed May 23rd 1900

Plaintiff

vs.

Viewers report accepted

and road ordered opened
By order of the board

Oct 10 - 1900

Defendant

Action for

Protest filed 4/10/13th
1900, by Mrs. Jennie Kamp.

No further action having ever been taken
by the Board and the petition filed by
St. Callentine, et al; taking the place of
this petition, the present Board
hereby declares above action
rescinded.

Geo. E. Davis
Chairman.

Dated March 7, 1904

Attorney for Plaintiff

See Vol 9, Court Journal
Page 430

Attorney for Defendant

Geo. D. Barnard & Co., St. Louis, Mo.

Filed May 23rd 1900

To be viewed June 29th
1900.

Viewers notified and
notices posted at the
Recorder's Office
June 12th 1900.

REPRODUCED FROM THE ORIGINAL RECORDS OF THE
GALLATIN COUNTY DISTRICT COURT, MONTANA.
Manufactured by Continental Paper Novelty Company,
109 Walnut Street, Cincinnati, O.
Patented March 1, 1900

PETITION FOR ROAD.

Hon. Board of County Commissioners
 To the County Surveyor of Gallatin County, Montana:

The Undersigned, your petitioners, citizens of the United States, respectfully show and represent that they are residents of Road District No. 0, in the County of Gallatin, State of Montana, where the road hereafter petitioned for, is to be located, laid out and established, if this petition be granted. That the proposed road will be a public convenience, and, we think, the public good requires it.

Your petitioners do respectfully ask and petition that a County road, sixty feet in width, to be a public highway, be laid out, located and established, and show:— (a) The general route of the proposed road; (b) over what lands it is proposed to be established; (c) who are the owners thereof; (d) whether such of them as can be found, consent thereto; (e) who of them do not consent; (f) the probable cost of the right-of-way where such consent is not had; (g) the necessity for and the advantages of the proposed road as follows, to-wit:

Starting on the Town Ship line & at quarter Rock between Section 18, owned by J. B. Morgan no damage. ^{T.3N. R.3E} and 13, owned by Mrs Jennie Kamp damage not known. ^{T.3N. R.4E}
 And following line North 1/4 mi to corner of Section 12, ^{T.3N. R.4E} & 7, ^{T.3N. R.5E} then a North Easterly course through Sec 7, owned by Mrs Jennie Kamp damage unknown striking Sec line about one quarter ^{mi} East of Town Ship line. Then running a North Easterly direction through Sec 6, ^{T.3N. R.5E} owned by Thom C. Dudley & John C. No damage striking the quarter Rock on North line (then plunging South on line between Pitman and Jordan through unsurveyed land) then running North 1 mile ^{on line} through unsurveyed land owned by Dudley Pitman, C. Jordan Sam Duncan Frank Wood No Damage. Intersecting with Jordan Road at quarter Rock
 Necessity of Road for children to have a way to go to School as many as 20 & far settlers to have an outlet to R.R. and other things to numerous to mention

- NAMES:
- 1 J. L. Huffine
 - 2 Sam Duncan
 - 3 F. B. Wood
 - 4 Levi M. Stoughton
 - 5 Frank Callantine

- NAMES:
- 6 J. H. Pitman
 - 7 L. J. Callantine
 - 8 J. Callantine
 - 9 W. B. Morgan
 - 10 J. J. Morgan

W. B. Huffine
 H. E. Richmond
 W. B. Ballinger
 C. Brown
 R. J. Durham

OFFICE OF

County Clerk and Recorder,

GALLATIN COUNTY, MONTANA.

HON. J. L. PATTERSON,
Chairman of the Board of County Commissioners, Gallatin County, Montana.

DEAR SIR:—You are hereby notified that a petition for a County Road has been received in this office,

signed by *D. H. Pitman*

of Road District No 6.

The petition above referred to, petitions that a Road be established, commencing

Starting on the Tp. line at "Quarter Rock" between Sec. 13, Tp. 3, N. R. 5 E, and Sec. 13 Tp. 3 N, R 4 E. thence following North 1/2 mile to corner of Sections 12 & 7; thence in a Northeasterly course through Sec 7 striking Sec. line about one quarter of a mile East of Township line; thence running in a Northeasterly direction through Sec. 6 striking the Quarter Rock on North line; thence running North one mile on line through unsurveyed land, owned by Dudley Pitman, C. Jordan, Sam Duncan, and Frank Wood intersecting with "Jordan Road" at Quarter Section Corner.

You are hereby notified to appoint three Viewers to view the above proposed Road.

Yours, Very Respectfully,

E. V. Blankenship

County Clerk and Recorder.

Dated at, Bozeman, Montana, this *26th* day of *May* 1900.

OFFICE OF

The Board of County Commissioners,

GALLATIN COUNTY, MONTANA.

MR. E. V. BLANKENSHIP,
County Clerk, Gallatin County, Montana.

DEAR SIR:—In pursuance of the above notice, I hereby appoint:

C. M. Huspe

D. H. Pitman

B. A. Duncan

to act in behalf of the Board of County Commissioners as viewers of the above petitioned Road

Yours, Very Respectfully,

J. L. Patterson

Chairman of the Board of County Commissioners, Gallatin County, Montana.

Dated at Bozeman, Montana, this *26* day of *May* 1900.

Warrant for Road Viewers.

County Clerk's Office, }
Gallatin County, Montana. }

Messrs C. M. Thorpe D. H. Pitman & B. S. Duncan

You are hereby notified that you were duly appointed Road Viewer by Mr. J. L. Patterson
Chairman of the Board of County Commissioners of Gallatin County, Montana, on the 20th
day of May A. D. 1900, to view and lay out a proposed road, as prayed for in the
petition of D. H. Pitman and others, described as follows, to-wit:

Starting on the Tp. line at "Quarter Rock" between Sec. 10, Tp. 3, N. 2, S. E. and
Sec. 13 Tp. 3 N. R. 4, E. thence following North 1/2 mile to corner of Sec-
tions 12 & 7; thence in a Northeasterly course through Sec 7 striking
Sec. line about one quarter of a mile East of Township line; thence run-
ning in a Northeasterly direction through Sec. 6 Striking the Quarter
Rock on North line; thence running North one mile on line through unsar-
veyed land, owned by Dudley Pitman, C. Jordan, Sam Duncan, and Frank Wood.
Intersecting with "Jordan Road" at Quarter Section Corner.

Copy

You are hereby ordered to meet, to be sworn according to law and assume the duties of your office, in
company with names of viewers, who were duly appointed as
Viewers on said road by the Chairman of the Board of County Commissioners, on the 20th
day of June A. D. 1900, commencing at the place designated in said petition as the
starting point of the road sought to be at Ten (10) O'Clock A.M. and proceed to view and
lay out the same by setting stakes, blazing trees, turning furrows, or other appropriate monuments to the
terminus named in said petition, by the most practical route that you in your judgment can find.
You shall notify the resident owner or agent of land over which it passes, of the proposed route; ascertain
whether such owner consents thereto and the amount of damages, if any, claimed or demanded for the
right of way over the same. You shall estimate the actual damage to any land over which the proposed
road passes and the cost of any bridges or grading necessary. You shall report the necessity for and the
public convenience to be subserved by the highway, if opened, and whether the opening thereof or the
change therein proposed should be made, and make and sign a report of your proceedings, as required by law.

Roads shall, in all cases, when practical, be laid out on subdivisional or section lines.

In witness whereof I hereunto set my hand, at my office this 12th
day of June A. D. 1900.

E. V. Blankenship
County Clerk

By Deputy.

Oath of Road Viewers.

STATE OF MONTANA, }
County of Gallatin. } SS.

I, the undersigned, having been appointed a road viewer, do hereby solemnly swear that I will faithfully and impartially perform, according to law, the duties of ROAD VIEWER, as per instructions embodied in the notice of appointment by the Board of County Commissioners.

E. M. Thorne

Subscribed and sworn to before me this 22nd day
of June 1900

E. V. Blankenship
County Clerk

This must be returned to the County Clerk after execution.

Oath of Road Viewers.

STATE OF MONTANA, }
County of Gallatin. } SS.

I, the undersigned, having been appointed a road viewer, do hereby solemnly swear that I will faithfully and impartially perform, according to law, the duties of ROAD VIEWER, as per instructions embodied in the notice of appointment by the Board of County Commissioners.

B. S. Duncan

Subscribed and sworn to before me this 29th day
of June 1900

E. M. Thorne
Co. Surveyor

This must be returned to the County Clerk after execution.

Oath of Road Viewers.

STATE OF MONTANA, }
County of Gallatin. } SS.

I, the undersigned, having been appointed a road viewer, do hereby solemnly swear that I will faithfully and impartially perform, according to law, the duties of ROAD VIEWER, as per instructions embodied in the notice of appointment by the Board of County Commissioners.

D. H. Pitman

Subscribed and sworn to before me this 29th day
of June 1900

C. M. Throop
Co. Surveyor

This must be returned to the County Clerk after execution.

To the Honorable Board of
County Commissioners of Gallatin
County.

Gentlemen:

We the undersigned parties to
be benefited by the opening of
the road petitioned for by
D. H. Pitman, agree to do the
necessary grading required
to open the same for travel.

D. H. Pitman

Frank Callantine provided road is laid
out along west line of Sec 77. 2N. 10E.

Thomas Callantine

Sam Duncan

J. B. Wood

B. L. Stiff

John Callantine

C. M. Throop

J. T. Huffine

E. J. Callantine

REPORT OF ROAD VIEWERS.

ROAD NO. 176

TO THE HONORABLE BOARD OF COUNTY COMMISSIONERS OF GALLATIN COUNTY, MONTANA:

We, the undersigned Road Viewers, consisting of D. H. Pitman, B. S. Duncan
and C. M. Thorpe, who were appointed by John Patterson
chairman of the Board of County Commissioners

appointed to view a proposed road running from the west 1/4 Sec. Corner of Sec. 18
T. 3 N. R. 5 E.

to the Jordan Road intersecting the same near the N 1/4 Sec. Cor. of
Sec. 31 T. 4 N. R. 5 E.

as described in the annexed petition, say, That on the 29th day of June
A. D., 1900 we assembled at the place designated in the petition, as the starting point of such proposed
road and proceeded to view the same, and submit the following report:

1. The width of the proposed road, the description of the center line of the same, the length, how
defined, the marks and sources, grades, character of ground, description of the land and owners of the
same, over which the proposed road passes, and probable cost of constructing the said road, as follows:

The width of the proposed road is 60 feet
The description of the center line of the proposed road
is as follows to-wit: Beginning at the 1/4 Section
Corner between Section 18 T. 3 N. R. 5 E. and Section
13 T. 3 N. R. 4 E. thence north to swamp, thence N. by & N. W. by
around the east end of the swamp to section line between said
sections 18, & 13, thence north along section line to a
point near the N. W. corner of said Sec. 18, thence
North easterly crossing the N. line of said Sec. 18 about
100 feet East of the N. W. corner thereof, thence north easterly
running up the gulch along or near the road as now traveled
through Section 7 T. 3 N. R. 5 E. Crossing the north line of said
Section about 1/4 mile East of N. W. corner thereof, thence
northeasterly through Section 6 T. 3 N. R. 5 E. to the N. 1/4 Section
Corner of said Section 6. Thence northerly through the
SW 1/4 of Section 31 T. 4 N. R. 5 E. keeping near the East line
of the same to a point on the N. & S. 1/4 Section line a short distance
north of the center of said Section, thence north along said N. & S.
1/4 Sec. line to the Jordan Road, intersecting the same near the
N. 1/4 Sec. corner of said Sec. 31, the same being the terminus as
described in the petition. The length of the proposed
road is about 3 1/2 miles. The line of the proposed road
is defined by stakes, mounds of rock, blazed trees and
fence posts. A survey would be necessary to properly
establish the line of the road. The grades of the proposed
road would not exceed 8% when properly constructed.
The character of the ground is hard and suitable for road
building.

over.

over which the proposed road passes
 the description of the land, and the name of the owners of
 the same are as follows.

N.E. 1/4 of Sec. 13 T.3N. R.4E	owned by Mrs. J. Kamps.
S. 1/2 of N.W. 1/4 of Sec. 18 T.3N. R.5E.	" " L.S. Morgan.
N. 1/2 " " " " " " " " " "	" " Frank Calcutt.
Section 7 " " " " " " " "	" " Mrs. J. Kamps.
S.W. 1/4 of " 6 " " " " " " "	" " + James Calcutt.
N.W. 1/4 " " " " " " " " " "	" " D.H. Pitman.
N.E. 1/4 " " " " " " " " " "	" " John Calcutt.
S.W. 1/4 " " 31 T.4N. R.5E. " " " "	" " D.H. Pitman.
N.W. 1/4 " " " " " " " " " "	" " S.D. Dimean.
N.E. 1/4 " " " " " " " " " "	" " Frank B. Ward.

The probable cost of constructing the proposed road sufficient
 for safe travel is, for the following culverts.

2 culverts 1x1x16	}	\$41.28
1 culvert 2x2x16		
1 culvert 3x6x16		
Flows for cattle pass.		
Grading		185.50
Total probable cost.		\$226.78

The parties to be benefited by the proposed road agree
 to do the necessary grading to open the road for travel,
 provided the County will build the culverts and bridges,
 and furnish tools and the Road Supervisor to take charge
 of the work.

BEFORE OF BOARD MEMBERS

2. The names of the land owners who consent to give the right of way, and we hereto attach their written consent, as follows:

Frank Calentine, Thomas Calentine, D. H. Pitman
John Calentine Road, S. D. Duncan, F. B. Wood

3. The names of the land owners who do not consent, and the amount of damages claimed by each, as follows:

L. S. Morgan claims \$100.00 and 50 rods of fence which would probably cost \$20.00
Mrs. J. Kamps claims \$700.00

4. The estimate of damages in excess of benefits to the owner of any land over which it is proposed to run the highway, as follows:

Regarding the claim of L. S. Morgan we would recommend that the same be not allowed as we believe the benefits to his property resulting from said road will fully equal the damages. Regarding the claim of Mrs. J. Kamps, as she needs the road for marketing her grain and in getting to her land in Sec. 7 we believe the benefits to be derived from said road will fully equal all the damages to her property.

5. The following facts, bearing upon the subject, which may be of importance to the Board:

The proposed road is needed as an outlet for several settlers, also for school children in going to school as the site for the school house has been located at the starting point of the proposed road. The road is also needed for hauling grain to Mandan.

We believe said road _____ to be practical and _____ of public utility and necessity and do _____ recommend the establishment of the same.

Dated June 30 A. D., 1890

C. M. Thorpe
B. S. Duncan
D. H. Pitman

Road Viewers.

To the Honorable Board of
County Commissioners of Gallatin
County.

Gentlemen:-

We the undersigned parties to
be benefited by the opening of
the road petitioned for by
D.H. Pitman, ^{et al} agree to do the
messing grading required
to open the same for travel.

D H Pitman

Frank Callantine provided road is laid
out along west line of Sec 7 T. 3 N. R 5 E.

Thomas Callantine

Sam Duncan

J. B. Wood

B. L. Stiff.

John Callantine

C. C. McBroos

J. T. Huffine

E J Callantine

We also examined a proposed route
for a road which leaves the line of
road as petitioned for on the S.W. 1/4
of Sec 7 T. 3 N. R. 5 E. running N.W. by
along the road as traversed, up a gulch
to West line of Sec. 7, thence north along
Sec line to about 1/4 mile N. of
the N.W. Cor. of Sec. 7 thence N.E. by
intersecting the road as petitioned for
North East of D.H. Pitman's house.

The object of this change is to give an
outlet for Levi McCullough and
Frank Calentine. The grade would
not exceed 8% or 9% it would
require more grading than
the route as petitioned for.
It being rather more hilly and not

give all parties an outlet which
would be given one by the road as
petitioned for, and would ^{in addition} give
L. McCullough & Frank Calentine,
an outlet which the road as
petitioned for does not.

The right of way might be more
easily obtained from J. Kamps on
this route than on the other.

To the County of Gallatin, State of Montana:

I Hereby Agree, and consent to give 30 feet for a Right of Way, for a County Road, through or along the East line of NE 1/4 of Sec. 12, T. 3 N. R. 4 E., and 60 feet when required, as viewed and surveyed by B.S. Dimean, D.H. Pitman + C.M. Thorpe on the 30th day of June, 1890. And hereby agree to place my fences on said lines without charge to the County.

Signed: Levi McCallough

Dated at this 30 day of June 1890

To the County of Gallatin, State of Montana:

I Hereby Agree, and consent to give 30 feet for a Right of Way, for a County Road, through or along the West side of NE 1/4 of Sec. 31, T. 4 N. R. 5 E., as viewed and surveyed by B.S. Dimean, D.H. Pitman + C.M. Thorpe on the 30th day of June, 1890. And hereby agree to place my fences on said lines without charge to the County.

Signed: J. B. Wood

Dated at this 30 day of June 1890

To the County of Gallatin, State of Montana:

I Hereby Agree, and consent to give 30 feet for a Right of Way, for a County Road, through or along the East side of NW 1/4 of Sec. 31, T. 4 N. R. 5 E., as viewed and surveyed by D.H. Pitman, B.S. Dimean + C.M. Thorpe on the 29th day of June, 1890. And hereby agree to place my fences on said lines without charge to the County.

Signed: Sam Dimean

Dated at this 29th day of June 1890

To the County of Gallatin, State of Montana:

I Hereby Agree, and consent to give 30 feet for a Right of Way, for a County Road, through or along the w. side of NW 1/4 of NW 1/4 of Sec. 18, T. 3 N., R. 5 E., and 60 feet near N.W. corner of said NW 1/4 of NW 1/4 as viewed and surveyed by B.S. Duncan D.H. Pitman + C.M. Thobe on the 29th day of June, 1890. And hereby agree to place my fences on said lines without charge to the County.

Signed: Frank Callantine

Dated at this 29th day of June 1890.

To the County of Gallatin, State of Montana:

I Hereby Agree, and consent to give 30 feet for a Right of Way, for a County Road, through or along the west side of NE 1/4 of Sec. 6, T. 3 N., R. 5 E., as viewed and surveyed by D.H. Pitman, B.S. Duncan + C.M. Thobe on the 29th day of June, 1890. And hereby agree to place my fences on said lines without charge to the County.

Signed: John Callantine

Dated at this 29th day of June 1890.

To the County of Gallatin, State of Montana:

I Hereby Agree, and consent to give 60 feet for a Right of Way, for a County Road, through or along the S.W. 1/4 of Sec. 6, T. 3 N., R. 5 E., as viewed and surveyed by B.S. Duncan D.H. Pitman + C.M. Thobe on the 29th day of June, 1890. And hereby agree to place my fences on said lines without charge to the County.

Signed: Thomas Callantine

Dated at this 30 day of June 1890.

T. Callantine

To the County of Gallatin, State of Montana:

I Hereby Agree, and consent to give 60 feet for a Right of Way, for a County Road, through or along the S W 1/4 of Sec. 31, T. 4 N. R. 5 E., as viewed and surveyed by B.S. Dunean D.H. Pitman + C.M. Hoop on the 30th day of June, 1890. And hereby agree to place my fences on said lines without charge to the County.

Signed: D.H. Pitman

Dated at this 30th day of June 1890.

Greg Sullivan

read as follows: "Subdivision applicants should be

To the County of Gallatin, State of Montana:

I Hereby Agree, and consent to give 30 feet for a Right of Way, for a County Road, through or along the East line of N W 1/4 of Sec. 6, T. 3 N. R. 5 E., and 60 feet where required as viewed and surveyed by B.S. Dunean + D.H. Pitman + C.M. Hoop on the 30 day of June, 1890. And hereby agree to place my fences on said lines without charge to the County.

Signed: D.H. Pitman

Dated at this 30th day of June 1890.

do

To the County of Gallatin, State of Montana:

I Hereby Agree, and consent to give 60 feet for a Right of Way, for a County Road, through or along the ~~Sec~~ ^{on the west side of S.E. 1/4 of it} ~~Sec~~ ^{at point where required} Sec. 31, T. 4 N. R. 5 E. E., as viewed and surveyed by B.S. Dunean D.H. Pitman + C.M. Hoop on the 30 day of June, 1890. And hereby agree to place my fences on said lines ~~without charge to the County.~~ ^{for the County to furnish 3 miles + posts for 1/4 mile of fence}

Signed: C.E. Jordan

Dated at this 30 day of June 1890.

To the County of Gallatin, State of Montana:

I Hereby Agree, and consent to give 30 feet for a Right of Way, for a County Road, through or along the East line of S.E. 1/4 of Sec. 12 T. 3 N. R. 4 E., also along the E. line of Sec 1 east 70 R. and 60 feet when required, as viewed and surveyed by B. S. Duncan, D. H. Pitman & C. M. Cook on the 30th day of June, 1890. And hereby agree to place my fences on said lines without charge to the County.

Signed: Grandallantine

Dated at this 30 day of June 1890.



In the Commissioners Court of the County of Gallatin, State of Montana.

In the Matter of the Petition of J. T. Huffine, D. H. Pitman et al, for a road.

To the Honorable Board of Commissioners of the County of Gallatin, State of Montana,

Gentlemen:-

You are hereby notified that the undersigned Mrs. Jennie Kamp hereby refuses and rejects the alleged action of your honorable body claimed to be had on the 10th day of October, 1900, whereby your honorable body awarded her no damages for the proposed construction of the road in said petition and report of viewers mentioned. She hereby refuses to accept the said award and demands that proceedings be taken by your honorable body under Section 2761 of the Political Code of Montana.

Mrs Jennie Kamp
BY Nelson & Hartman
Her Attorneys.

Service of the above notice accepted and the same filed in my office this 13th day of November, A.D. 1900.

E. V. Blaukenship
County Clerk and Recorder of Gallatin County, Montana.
By J. P. Morgan Dep.

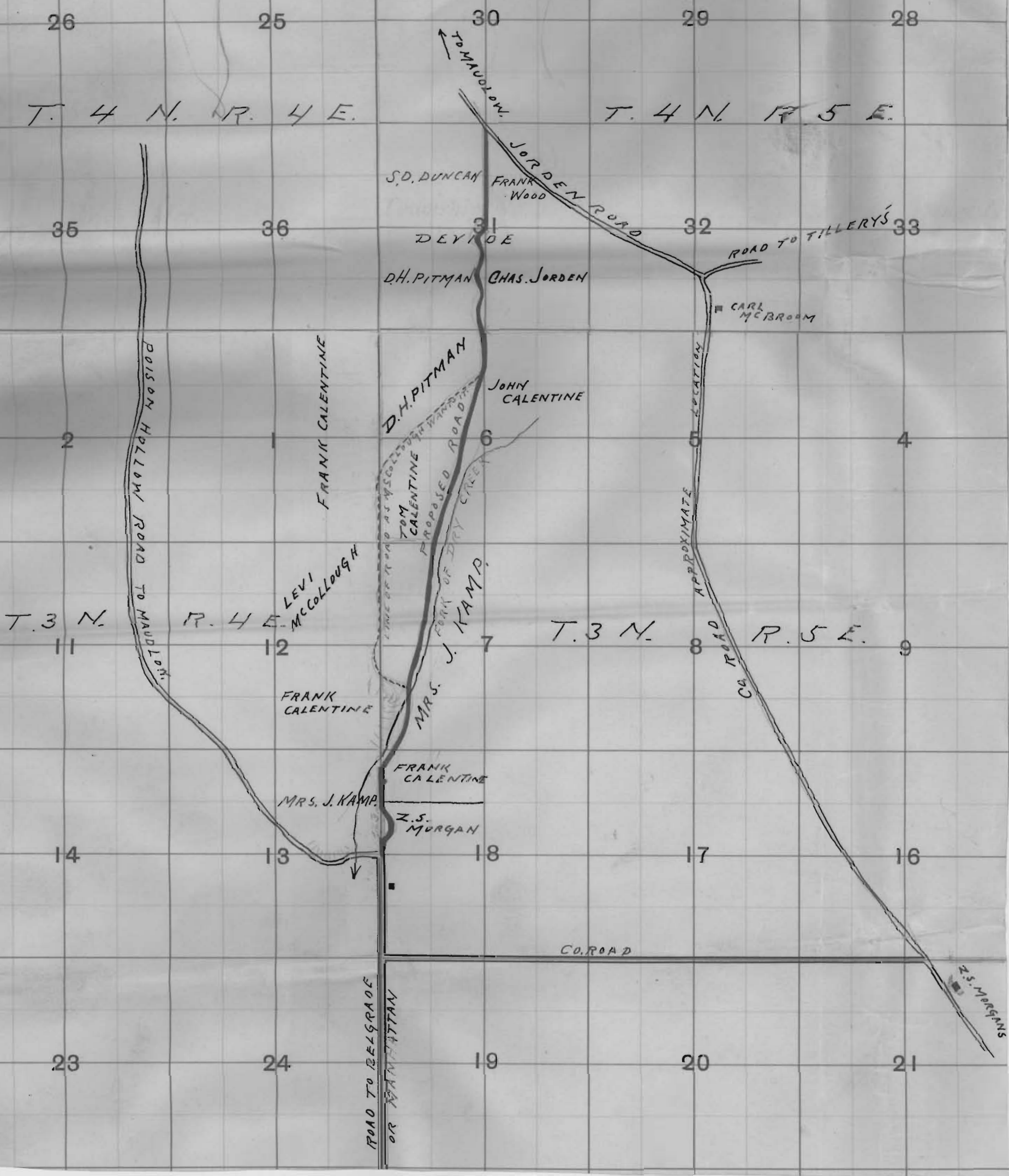

NOTICE OF PETITION FOR OPENING PUBLIC ROAD AND DATE OF VIEWING THE SAME.

Notice is hereby given that fifteen residents of Road Dist., No. 3 of Gallatin County, State of Montana, have filed a petition in writing with the County Commissioners of the County of Gallatin, State of Montana. Said petition praying that a new road be established.

A description of the route of the road which it is proposed to lay out and establish, is as follows, to-wit:- Starting on the Township line owned by Z. S. Morgan and 13 owned by Mrs. Jennie Kamp, thence following line North 1/2 mile to corner of Sections 12 & 7; thence in a Northeasterly course through Sec. 7 striking Sec. line about one quarter of a mile East of Township line; thence running in a Northeasterly direction through Sec. 6 Striking the Quarter Rock on North line; thence running North one mile on line through unsurveyed land, owned by Dudley Pitman, C. Jordan, Sam Duncan, and Frank Wood; intersecting with "Jordan Road" at Quarter Section corner.

Said Road is to commence on Tp. line between Sections 18-3 N-5 E. and Sec. 13-3 N-4 E, thence running according to the above description and terminating on the North line of Sec. 31, 4, N. R. 5 E.

Said proposed road will be viewed by viewers appointed by the Chairman of the Board of County Commissioners, according to law, who will commence said view at the place of beginning of said road so proposed to be established, on Friday the (29) twenty ninth day of June A. D. 1900. Said viewing to commence at ten (10) o'clock A. M. of said day.

Very Respectfully
E. B. Blaukenship
County Clerk of Gallatin County,
State of Montana.

STATE OF MONTANA, }
County of Gallatin. } ss.

Dudley Pitman being first duly sworn deposes and says, that as the he received from the County Clerk of said County, on the 12th day of June A. D., 1900, three copies of the annexed notice, and that on the 13 day of June 1900 he posted a copy of said notice at each of the following points, on the line of road described in said notice, to-wit: One at the beginning point and one at the terminating point.

and further deponeth sayeth not.

Subscribed and sworn to before me this 25 day of June A. D., 1900

Dudley Pitman
E. B. Blaukenship
O. P. Morgan dep

NOTICE OF PETITION FOR OPENING PUBLIC ROAD AND DATE OF VIEWING THE SAME.

NOTICE OF PETITION FOR OPENING PUBLIC ROAD AND DATE OF VIEWING THE SAME.

Notice is hereby given that fifteen residents of Road Dist., No. 6 have of Gallatin County, State of Montana, have filed a petition in writing with the County Commissioners of the County of Gallatin, State of Montana. Said petition praying that a new road be established.

A description of the route of the road which it is proposed to lay out and establish, is as follows, to-wit:-

Starting on the Township line, at "Quarter Rock" between Sections 18 owned by E.S. Morgan and 13 owned by Mrs. Jennie Kemp, thence following line North 1/2 mile to corner of Sections 12 & 7; thence in a Northeasterly course through Sec. 7 striking Sec. line about one quarter of a mile East of Township line; thence running in a Northeasterly direction through Sec. 6 striking the Quarter Rock on North line; thence running North one mile on line through unsurveyed land, owned by Dudley Pitman, C. Jordan, Sam Duncan, and Frank Wood; intersecting with "Jordan Road" at Quarter Section corner.

Said Road is to commence on Tp. line between Sections 18-3 N-5 E. and Sec. 13-3 N-4 E, thence running according to the above description and terminating on the North line of Sec. 31, 4, N. R. 5 E.

Said proposed road will be viewed by viewers appointed by the Chairman of the Board of County Commissioners, according to law, who will commence said view at the place of beginning of said road so proposed to be established, on Friday the (29) twenty ninth day of June A.D. 1900. Said viewing to commence at ten (10) o'clock A.M. of said day.

Very Respectfully
E. J. Blankenship
County Clerk of Gallatin County,
State of Montana.

I, hereby certify that I posted a copy of the annexed notice at the County Clerk and Recorder's Office on Tuesday the 12th day of June A.D. 1900.

E. J. Blankenship
Clerk and Recorder

Subscribed and sworn to before me this 6th day of Sept. 1900

C. M. Hooper
Co. Surveyor.

Please Drop my a
card and let me
no when this
petition will be
acted on and we
will come in and
explain the rest
D H Pitman
Taslat PA

Form 1548.
REGISTRY RETURN RECEIPT sent JUN 12 1900, 189

Reg. No. 282 from Post Office at Bozeman, Mont.

Reg. Letter / Addressed to D. H. Pitman
Reg. Parcel / Gallop Mont.

After obtaining receipt below, the Postmaster will mail this Card, without cover and without postage, to address on the other side.

RECEIVED THE ABOVE DESCRIBED REGISTERED LETTER PARCEL

Sender's name on other side. D H Pitman

SIGN ON DOTTED LINES TO THE RIGHT.

When delivery is made to other than address, the name of both address and recipient must appear.

* Erase letter or parcel according to which is sent.

JUN 12 9 30 AM 1900 REGD

Form 1548.
REGISTRY RETURN RECEIPT sent JUN 13 1900, 189

Reg. No. 284 from Post Office at Bozeman, Mont.

Reg. Letter / Addressed to C. M. Thorpe
Reg. Parcel / Bozeman, Mont.

After obtaining receipt below, the Postmaster will mail this Card, without cover and without postage, to address on the other side.

RECEIVED THE ABOVE DESCRIBED REGISTERED LETTER PARCEL

Sender's name on other side. C. M. Thorpe

SIGN ON DOTTED LINES TO THE RIGHT.

When delivery is made to other than address, the name of both address and recipient must appear.

* Erase letter or parcel according to which is sent.

REGISTRY RECEIPT.

Post Office at Bozeman, Mont.

Registered Letter / No. 284 Rec'd June 13 1900
Parcel / of C. M. Thorpe
Bozeman, Mont.

addressed to C. M. Thorpe
Bozeman, Mont.
J. H. B. Burkett P. M.

REGISTRY RECEIPT.

Bozeman, Mont.

Post Office at

Registered Letter Parcel

No. 281

Rec'd

June 12 1900

of

C. Clerk

Bozeman, Mont.

addressed to

B. S. Duncan

Gallop, Mont.

W. B. Burkitt

P. M.

REGISTRY RECEIPT.

Bozeman, Mont.

Post Office at

Registered Letter Parcel

No. 282

Rec'd

June 12-1900

of

C. Clerk

Bozeman, Mont.

addressed to

D. H. Pitman

Gallop, Mont.

W. B. Burkitt

P. M.